

Investitor:

**BASHKIA SHKODER**

Miratoi:

**KRYETAR  
VOLTANA ADEMI**

**Titulli i Projektit**

**RIKONSTRUKSION RRUGA "MENDAFSHIT"**

**PROJEKT ZBATIMI**

Autor

"NOVATECH STUDIO "SHPK



**ADMIN ING. EMIL NOVA**

ING. NDERTIME	Mimoza TOMCO
ARKITEKT	Gerta NOVA
ING. HIDROTEKNIK	Kostandin NOVA
ING. GJEDLOGJIK	Antonela BAZHDARI
ING. MEKANIK	Nikollaq DOKU
ING. ELEKTRIK	Marketin SHLLAKU

Vula

**HORROGRAFIA SHK 1:2500**  
**E RRUGES "FARRUKEJ" E VENDOSUR NE ORTOFOTON E**  
**ZONES VERIORE TE SHKODRES**



**HORROGRAFIA SHK 1:5000**  
**E RRUGES FARRUKEJ E VENDOSUR NE FRAGMENTIN**  
**E HARTES E HARTES TOPOGRAFIKE**



**Investitor:**  
**BASHKIA SHKODER**

**Miratoi:**  
**KRYETAR**  
**VOLTANA ADEMI**

**Vula**

**Titulli i Projektit**  
 RIKONSTRUKSION RRUGA "MENDAFSHIT"

**Faza** **PROJEKT ZBATIMI**

**Vula**

**Autor** "NOVATECH STUDIO "SHPK"  
  
**ADMIN ING. EMIL NOVA**

ING. NDERTIMI	Reshit BEDHIA
ING. NDERTIMI	Mirreza YOMCO
ARKITEKT	Gerda NOVA
ARKITEKT	Loreta FERRA
ING. HIDROTEKNIK	Kostandin NOVA
ING. GJERËDORJIK	Arbenis BAZDARI
ING. MEKANIK	Nikolina DOKU
ING. ELEKTRIK	Marketa SHLLAKU
ING. MEKANIK	Rubin KODRA

**Vula**

**Titulli i Vizatimit**  
 HORROGRAFIA

Realizuar	<b>2021</b>	<b>Shkalla</b>	<b>1:2500</b> <b>1:5000</b>
-----------	-------------	----------------	--------------------------------

Emërtimi i Fletës **H1 - 01**

# PLANIMETRIA E GJENDJES EKZISTUESE TE RRUGES SHK 1:250

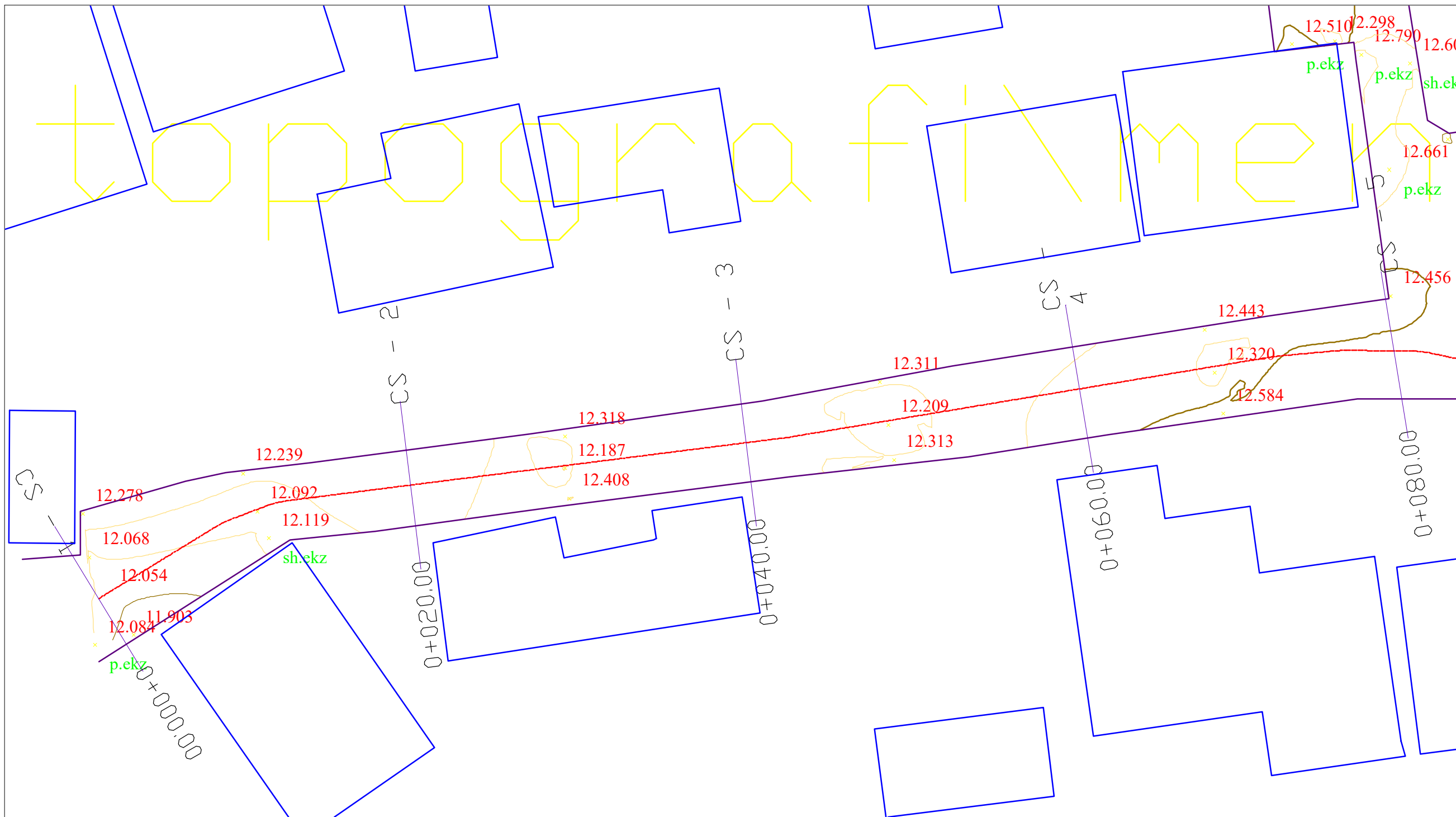

## Legjenda

- Aksi i rrugës
- 12.905 Kuota
- Izoipse
- Trotuar shtrese betoni
- CS - 1 Piketat
- Rrethime ekzistuese
- Ndertesa

**Investitor:**  
**BASHKIA SHKODER**

**Miratoi:**  
**KRYETAR**  
**VOLTANA ADEMI**

**Vula**  
 RIKONSTRUKSION RRUGA "MENDAFSHIT"

**Titulli i Projektit**

**Faza** **PROJEKT ZBATIMI**

**Vula**  
**Autor** "NOVATECH STUDIO "SHPK"  
  
**ADMIN ING. EMIL NOVA**

ING. NDERTIMI	Reshit BEDHIA
ING. NDERTIMI	Mimoza TOMCO
ARKITEKT	Gerda NOVA
ARKITEKT	Lorisa FERRO
ING. HIDROTEKNIK	Kostandin NOVA
ING. GJELBORGJIK	Antonina BAZHEKRI
ING. MEKANIK	Nikollas DOKU
ING. ELERTRIK	Marketin SHLLARU
ING. MEKANIK	Rubin KODRA

**Vula**

**Titulli i Vizatimit**  
 PLANIMETRIA E GJENDJES EKZISTUESE  
 TE RRUGES

Realizuar **2021** **Shkalla** **1:250**  
 Emërtimi i Fletës **A1 - 01**



# PLANIMETRIA E GJENDJES EKZISTUESE TE RRUGES SHK 1:250

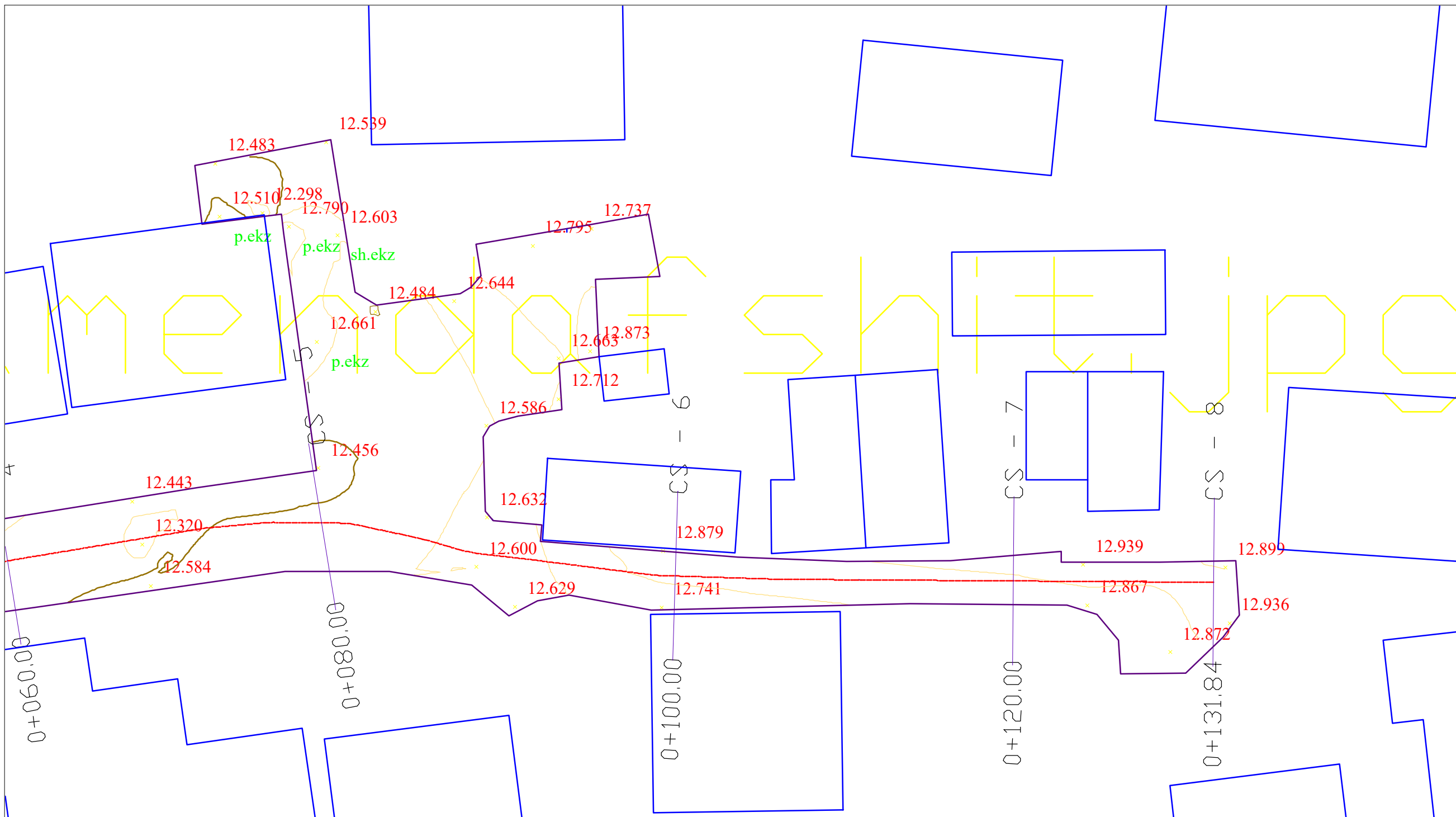

## Legjenda

- Aksi i rrugës
- 12.905 Kuota
- Izoipse
- Trotuar shtrese betoni
- Piketat
- Rrethime ekzistuese
- Ndertesat

### Investitor:

**BASHKIA SHKODER**

### Miratoi:

**KRYETAR  
VOLTANA ADEMI**

### Vula

RIKONSTRUKSION RRUGA "MENDAFSHIT"

### Titulli i Projektit

### Faza

**PROJEKT ZBATIMI**

### Vula

**Autor** "NOVATECH STUDIO "SHPK"



ING. NDERTIMI	Reshit BEDHIA
ING. NDERTIMI	Mimoza TOMCO
ARKITEKT	Gerda NOVA
ARKITEKT	Loreta FERRO
ING. HIDROTEKNIK	Kostandin NOVA
ING. GJELBORGJIK	Antonina BAZHEKRI
ING. MEKANIK	Nikollas DOKU
ING. ELERTRIK	Marketa SHLLARU
ING. MEKANIK	Rubin KODRA

### Vula

### Titulli i Vizatimit







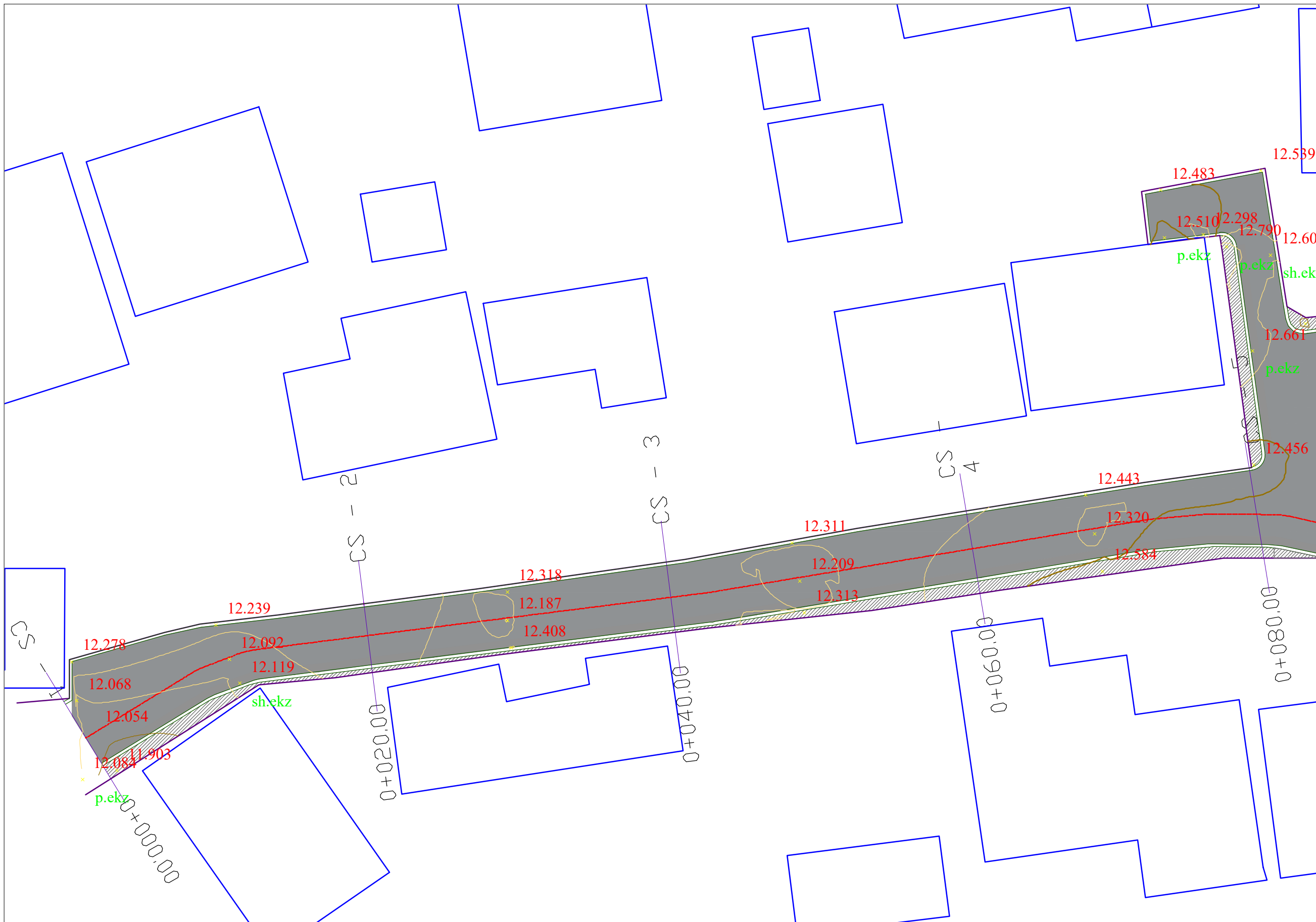

PLANIMETRIA E GJENDJES EKZISTUESE  
TE RRUGES

Realizuar **2021** Shkalla **1:250**

Emërtimi i Fletës **A1 - 02**

# PLANIMETRIA E E RRUGES SE "MENDAFSHIT" SHK 1:250



-  Trupi i rrugës
-  Aksi i rrugës
-  Kuota
-  Izoipse
-  Trotuar shtrese betoni
-  Piketat
-  Bordura
-  Ndertesat

Investitor:

**BASHKIA SHKODER**

Miratoi:

**KRYETAR  
VOLTANA ADEMI**

Vula

RIKONSTRUKSION RRUGA "MENDAFSHIT"

Titulli i Projektit

Faza **PROJEKT ZBATIMI**

Vula

Autor "NOVATECH STUDIO "SHPK"



ING. NDERTIMI	Reshit BEDHIA
ING. NDERTIMI	Mimoza TOMCO
ARKITEKT	Gerda NOVA
ARKITEKT	Loreta FERRO
ING. HIDROTEKNIK	Kostandin NOVA
ING. GJEOLGJIK	Antonina BAZHEARI
ING. MEKANIK	Nikollas DOKU
ING. ELERTRIK	Marketin SHELARU
ING. MEKANIK	Rubin KODRA

Vula

Titulli i Vizatimit

PLANIMETRIA E RRUGES

Realizuar **2021** Shkalla **1:250**

Emërtimi i Fletës **A1 - 03**

# PLANIMETRIA E E RRUGES SE "MENDAFSHIT" SHK 1:250



- Legjenda**
- Trupi i rrugës
  - Aksi i rrugës
  - Kuota
  - Izoipse
  - Trotuar shtrese betoni
  - Piketat
  - Bordura
  - Ndertesa

**Investitor:**  
**BASHKIA SHKODER**

**Miratoi:**  
**KRYETAR**  
**VOLTANA ADEMI**

**Vula**  
RIKONSTRUKSION RRUGA "MENDAFSHIT"

**Titulli i Projektit**

**Faza** **PROJEKT ZBATIMI**

**Vula**  
**Autor** "NOVATECH STUDIO "SHPK"  
  
**ADMIN ING. EMIL NOVA**

ING. NDERTIMI	Reshit BEDHIA
ING. NDERTIMI	Mimoza TOMCO
ARKITEKT	Gerda NOVA
ARKITEKT	Loreta FERRO
ING. HIDROTEKNIK	Kostandin NOVA
ING. GJELBEGJUK	Antonina BAZHEARI
ING. MEKANIK	Nikollas DOKU
ING. ELERTRIK	Marketin SHLLARU
ING. MEKANIK	Rubin KODRA

**Vula**

**Titulli i Vizatimit**  
**PLANIMETRIA E RRUGES**

Realizuar	<b>2021</b>	<b>Shkalla</b>	<b>1:250</b>
Emërtimi i Fletës		<b>A1 - 04</b>	

PLANIMETRIA E UJESJELLESIT, K.U.B DHE K.U.Z. TE RRUGES SE "MENDAFSHIT" SHK 1:250

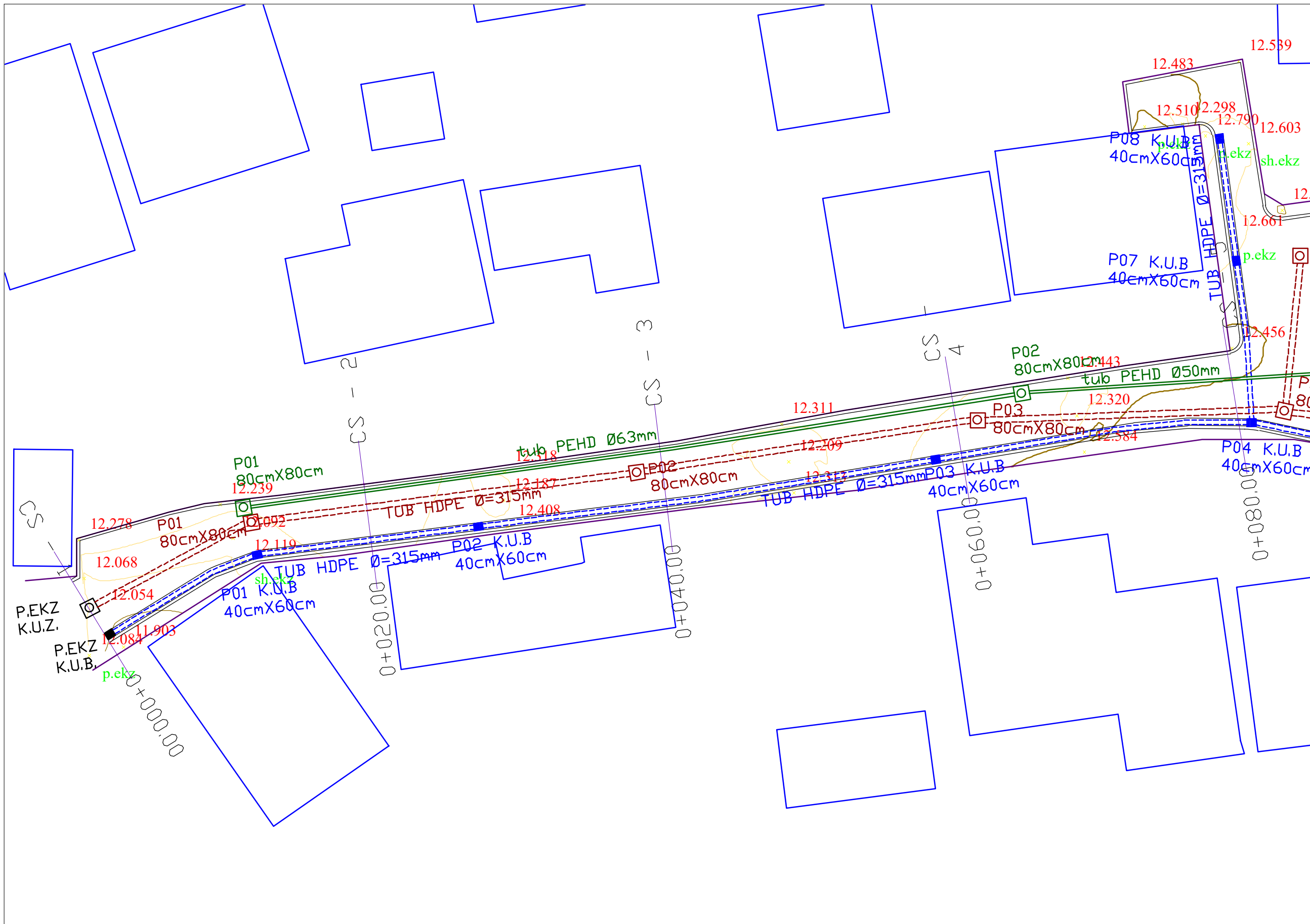

- Trupi i rrugës
- Aksi i rrugës
- Puseta
- Izoipse
- TUB HDPE Ø=315 mm
- Piketat
- TUB HDPE Ø=315mm
- TUB PEHD Ø=63mm
- Ndertesa

Investitor:

**BASHKIA SHKODER**

Miratoi:

**KRYETAR**

**VOLTANA ADEMI**

Vula

RIKONSTRUKSION RRUGA "MENDAFSHIT"

Titulli i Projektit

Faza

**PROJEKT ZBATIMI**

Vula

Autor "NOVATECH STUDIO "SHPK"



ING. NDERTIMI	Reshit BEDHIA
ING. NDERTIMI	Mimoza TOMCO
ARKITEKT	Gerda NOVA
ARKITEKT	Lorisa FERRO
ING. HIDROTEKNIK	Kostandin NOVA
ING. GJELBORGJIK	Antonina BAZHEARI
ING. MEKANIK	Nikollas DOKU
ING. ELERTRIK	Marketa SHLLARU
ING. MEKANIK	Rubin KODRA

Vula

Titulli i Vizatimit

PLANIMETRIA E UJESJELLESIT,  
K.U.B DHE K.U.Z. TE RRUGES

Realizuar **2021** Shkalla **1:250**

Emërtimi i Fletës

**A1 - 05**

PLANIMETRIA E UJESJELLESIT, K.U.B DHE K.U.Z. TE RRUGES SE "MENDAFSHIT" SHK 1:250

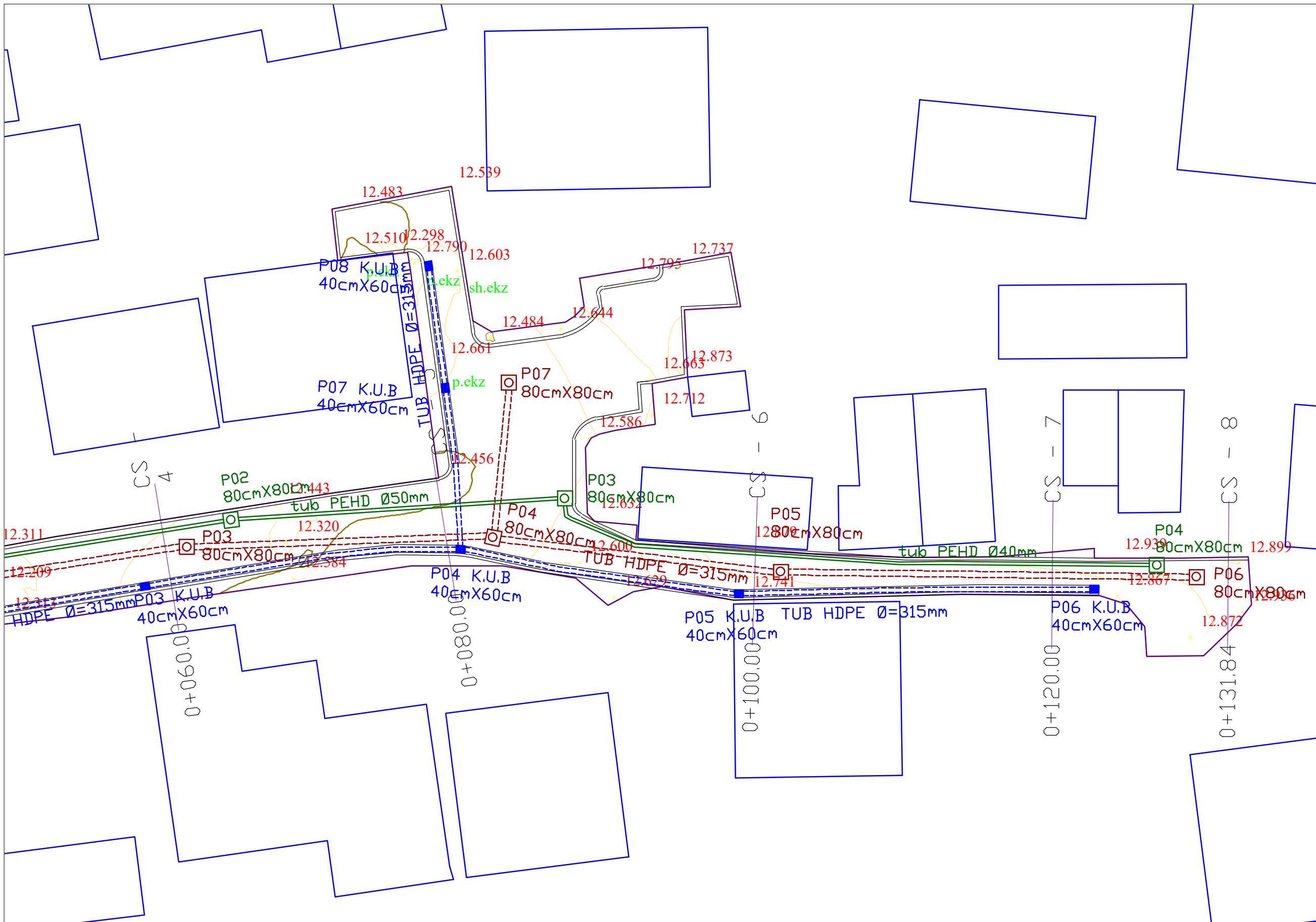

Legjenda

- Trupi i rrugës
- Aksi i rrugës
- Puseta
- Izoipse
- TUB HDPE Ø=315 mm
- Piketat
- TUB HDPE Ø=315mm
- TUB PEHD Ø=63mm
- Ndertesa

Investitor:

**BASHKIA SHKODER**

Miratoi:

**KRYETAR  
VOLTANA ADEMI**

Vula

RIKONSTRUKSION RRUGA "MENDAFSHIT"

Titulli i Projektit

Faza

**PROJEKT ZBATIMI**

Vula

Autor "NOVATECH STUDIO "SHPK"



ING. NDERTIMI	Reshit BEDHIA
ING. NDERTIMI	Mimoza TOMCO
ARKITEKT	Gerda NOVA
ARKITEKT	Lorisa FERRO
ING. HIDROTEKNIK	Kostandin NOVA
ING. GJELBORGJIK	Antonina BAZHEKRI
ING. MEKANIK	Nikollas DOKU
ING. ELERTRIK	Marketin SHELARU
ING. MEKANIK	Rubin KODRA

Vula

Titulli i Vizatimit

PLANIMETRIA E UJESJELLESIT,  
K.U.B DHE K.U.Z. TE RRUGES

Realizuar **2021** Shkalla **1:250**

Emërtimi i Fletës **A1 - 06**



PROFIL TIP 1  
pg.0-pg 080.00

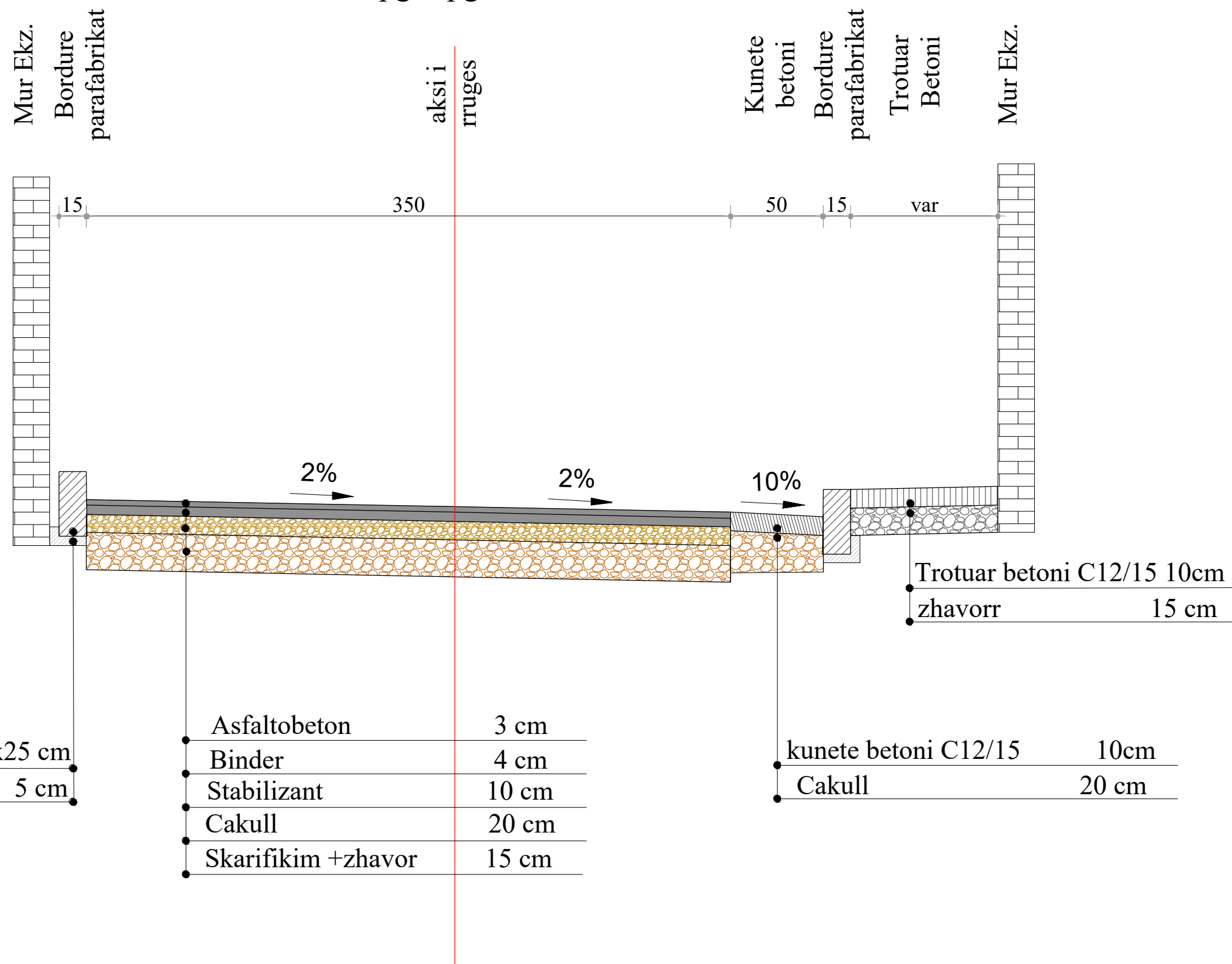

Bordure betoni paraf. 15x25 cm  
Shtrese betoni C7/10 5 cm

Asfaltobetoni	3 cm
Binder	4 cm
Stabilizant	10 cm
Cakull	20 cm
Skarifikim + zhavorr	15 cm

kunete betoni C12/15 10cm  
Cakull 20 cm

Trotuar betoni C12/15 10cm  
zhavorr 15 cm

**Investitor:**  
**BASHKIA SHKODER**

**Miratoi:**  
**KRYETAR**  
**VOLTANA ADEMI**

**Vula**  
RIKONSTRUKSION RRUGA "MENDAFSHIT"

**Titulli i Projektit**

**Faza** **PROJEKT ZBATIMI**

**Vula**  
**Autor** "NOVATECH STUDIO "SHPK"  
  
**ADMIN ING. EMIL NOVA**

ING. NDERTIMI Reshit BEDHIA  
ING. NDERTIMI Mimoza TOMCO  
ARKITEKT Gerda NOVA  
ARKITEKT Lorisa FERRO  
ING. HIDROTEKNIK Roslinda NOVA  
ING. GJEOLGJIK Antonia BAZDARI  
ING. MEKANIK Nikollas DOKU  
ING. ELERTRIK Marketa SHLLARU  
ING. MEKANIK Rubin KODRA

**Vula**

**Titulli i Vizatimit**  
PROFILAT TERTHORE TIP

Realizuar **2021** **Shkalla** **1:25**

Emërtimi i Fletës **B1 - 01**

PROFIL TIP 2  
pg080.0-pg125.0

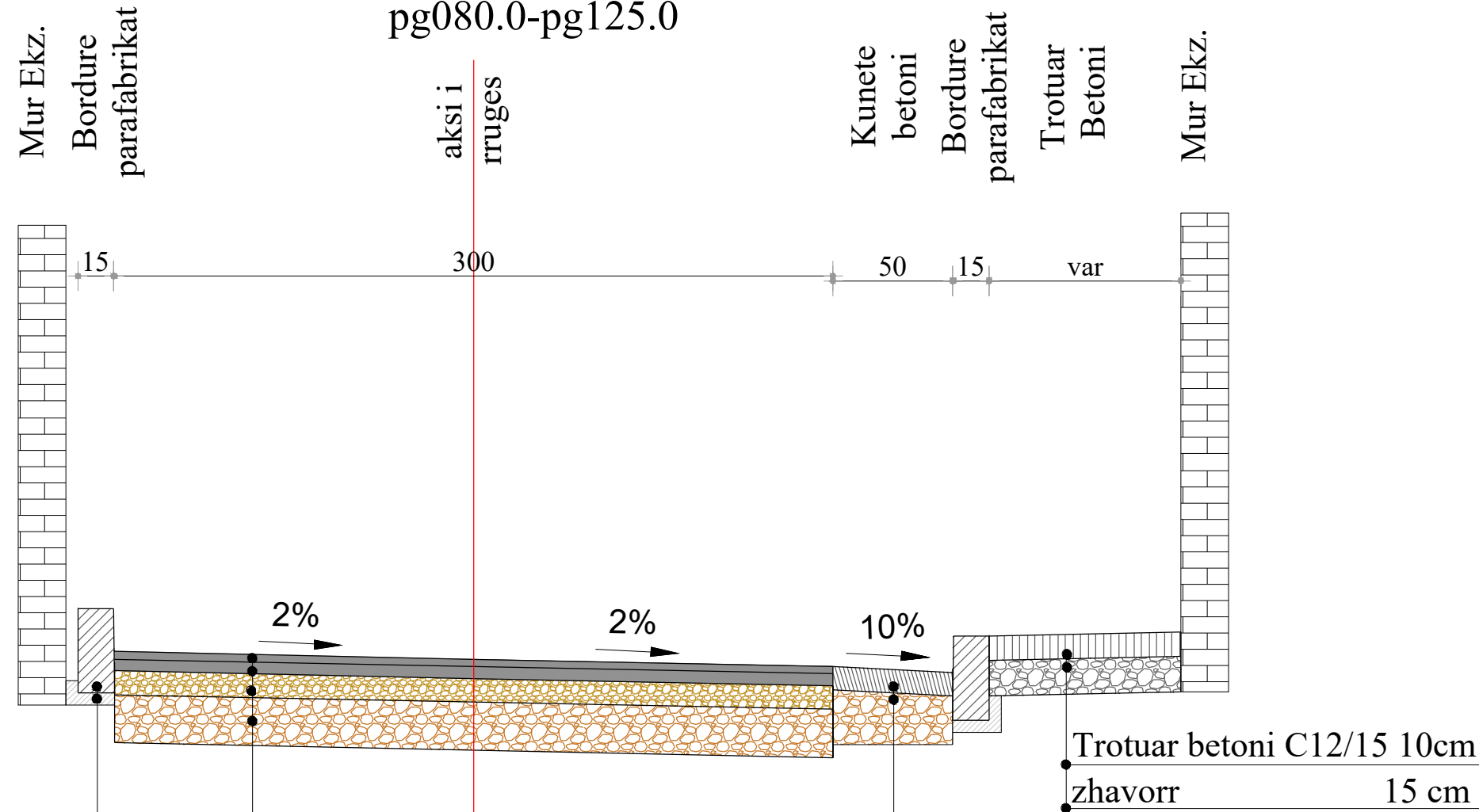

Bordure betoni paraf. 15x25 cm  
Shtrese beton C7/10 5 cm

Asfaltobeton	3 cm
Binder	4 cm
Stabilizant	10 cm
Cakull	20 cm
Skarifikim +zhavor	15 cm

kunete betoni C12/15	10cm
Cakull	20 cm

Investitor:

BASHKIA SHKODER

Miratoi:

KRYETAR  
VOLTANA ADEMI

Vula

RIKONSTRUKSION RRUGA "MENDAFSHIT"

Titulli i Projektit

Faza **PROJEKT ZBATIMI**

Vula

Autor "NOVATECH STUDIO "SHPK"

ADMIN ING. EMIL NOVA

ING. NDERTIMI	Reshit BEDHIA
ING. NDERTIMI	Mimoza TOMCO
ARKITEKT	Gerda NOVA
ARKITEKT	Loreta FERRO
ING. HIDROTEKNIK	Kostandin NOVA
ING. GJELBEGJIK	Antonina BAZHEARI
ING. MEKANIK	Nikollas DOKU
ING. ELERTRIK	Marketin SHLLARU
ING. MEKANIK	Rubin KODRA

Vula

Titulli i Vizatimit

PROFILAT TERTHORE TIP

Realizuar **2021** Shkalla **1:25**

Emërtimi i Fletës

**B1 - 02**

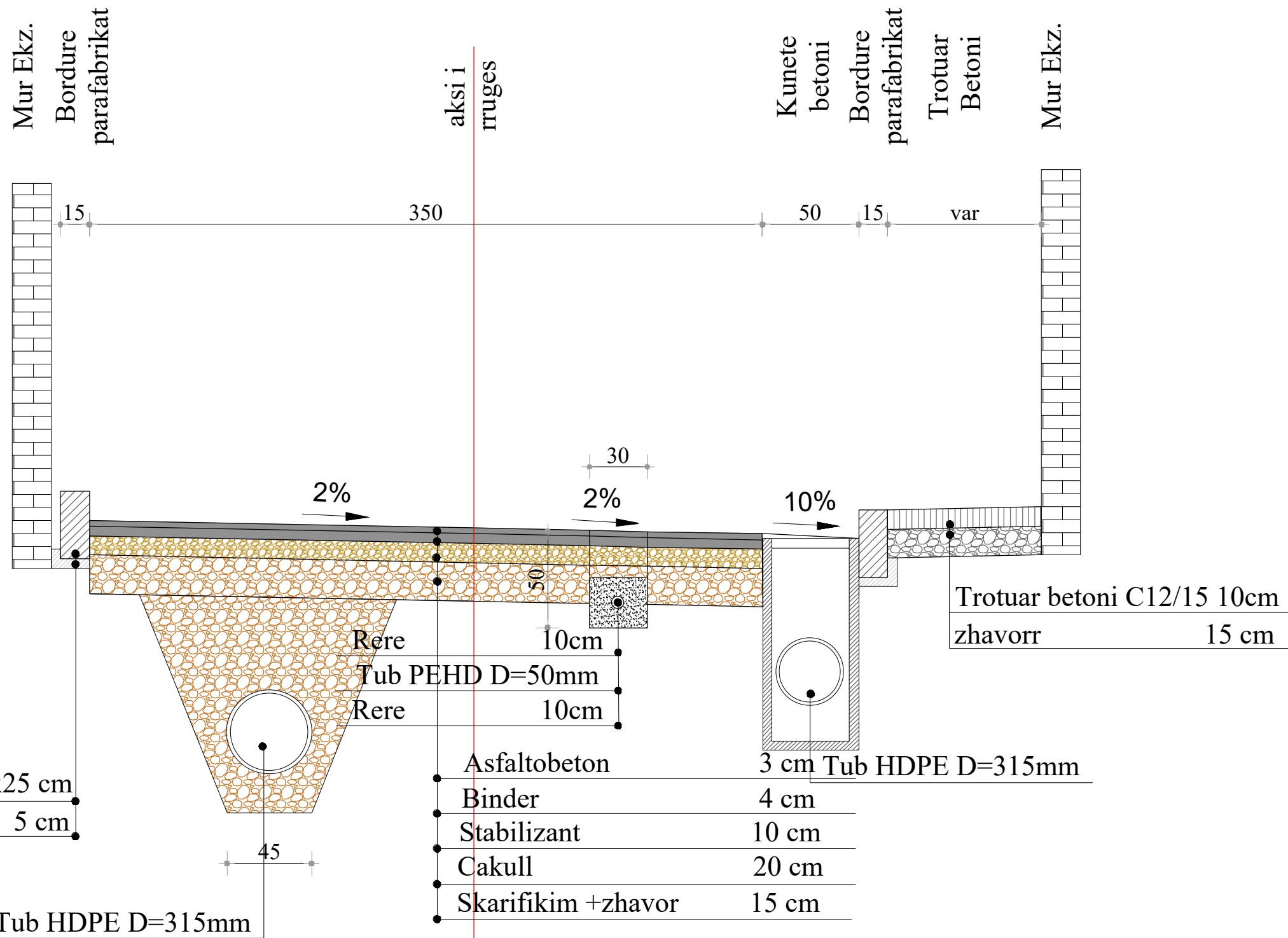

**Investitor:**  
BASHKIA SHKODER

**Miratoi:**  
KRYETAR  
VOLTANA ADEMI

**Vula**  
RIKONSTRUKSION RRUGA "MENDAFSHIT"

**Titulli i Projektit**

**Faza** PROJEKT ZBATIMI

**Vula**  
**Autor** "NOVATECH STUDIO "SHPK"

ADMIN ING. EMIL NOVA

ING. NDERTIMI	Reshit BEDHIA
ING. NDERTIMI	Mimoza TOMCO
ARKITEKT	Gerda NOVA
ARKITEKT	Lorisa FERRO
ING. HIDROTEKNIK	Kostandin NOVA
ING. GJEJLIGJIK	Antonina BAZHARI
ING. MEKANIK	Nikollas DOKU
ING. ELEKTRIK	Marketin SHLLARU
ING. MEKANIK	Rubin KODRA

**Vula**

**Titulli i Vizatimit**

PROFILAT TERTHORE TIP

Realizuar 2021 Shkalla 1:25

Emërtimi i Fletës B1 - 03

# DETAJE PUSETA E UJRAVE TE SHIUT PER DN Ø250/Ø315 mm PE

Pamje nga lart

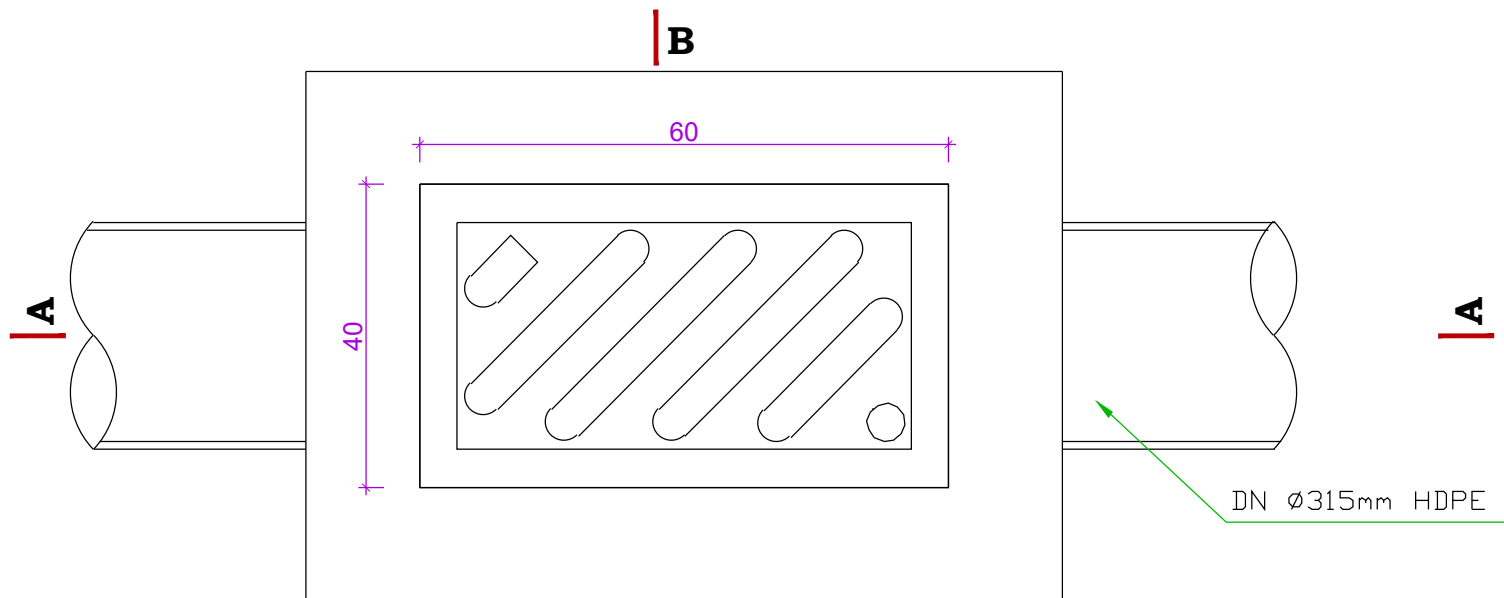

Kapaku

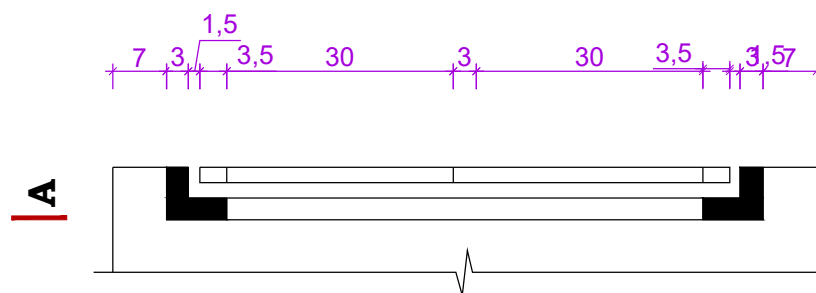

Prerja A-A

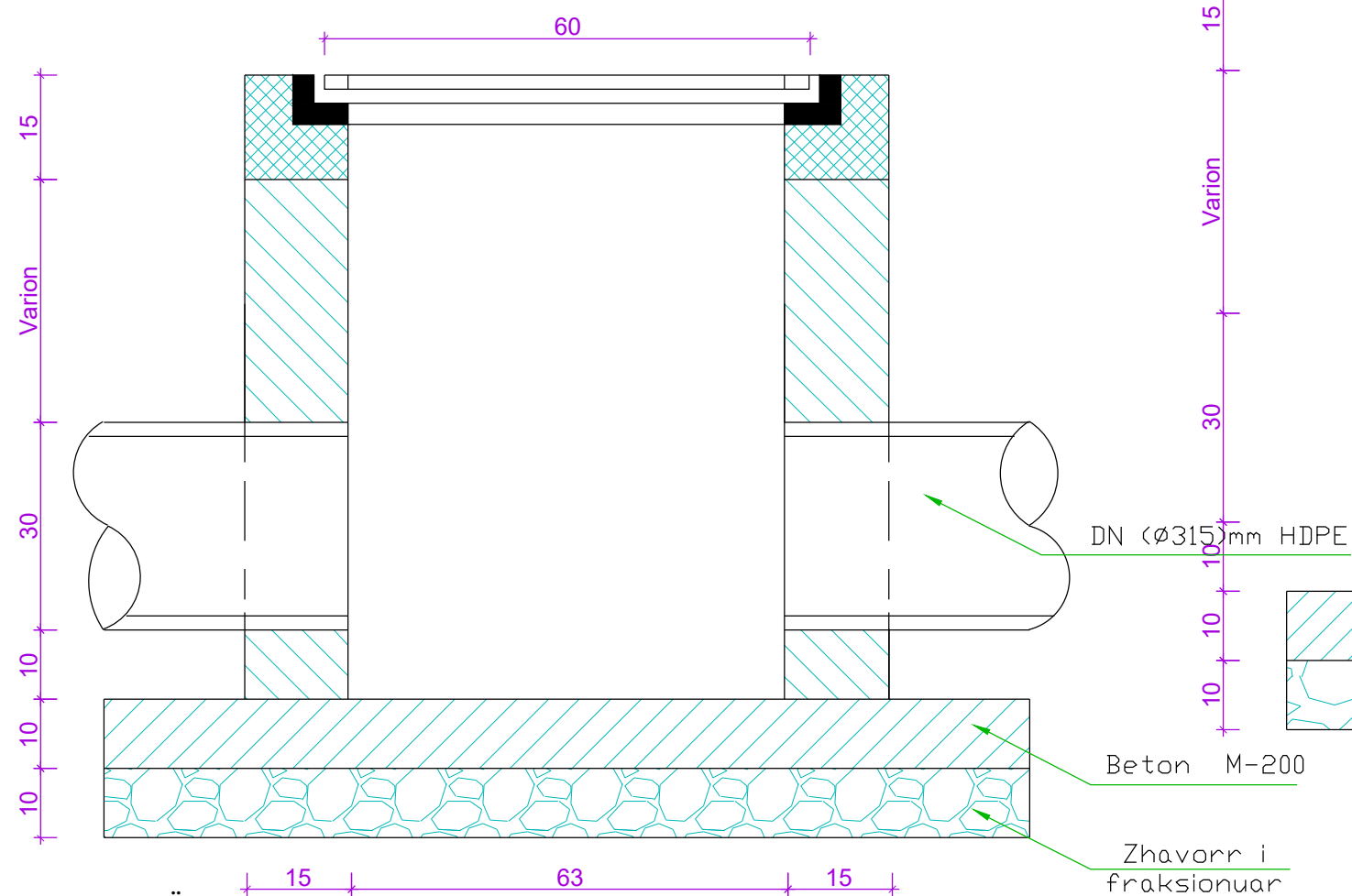

Prerja B-B

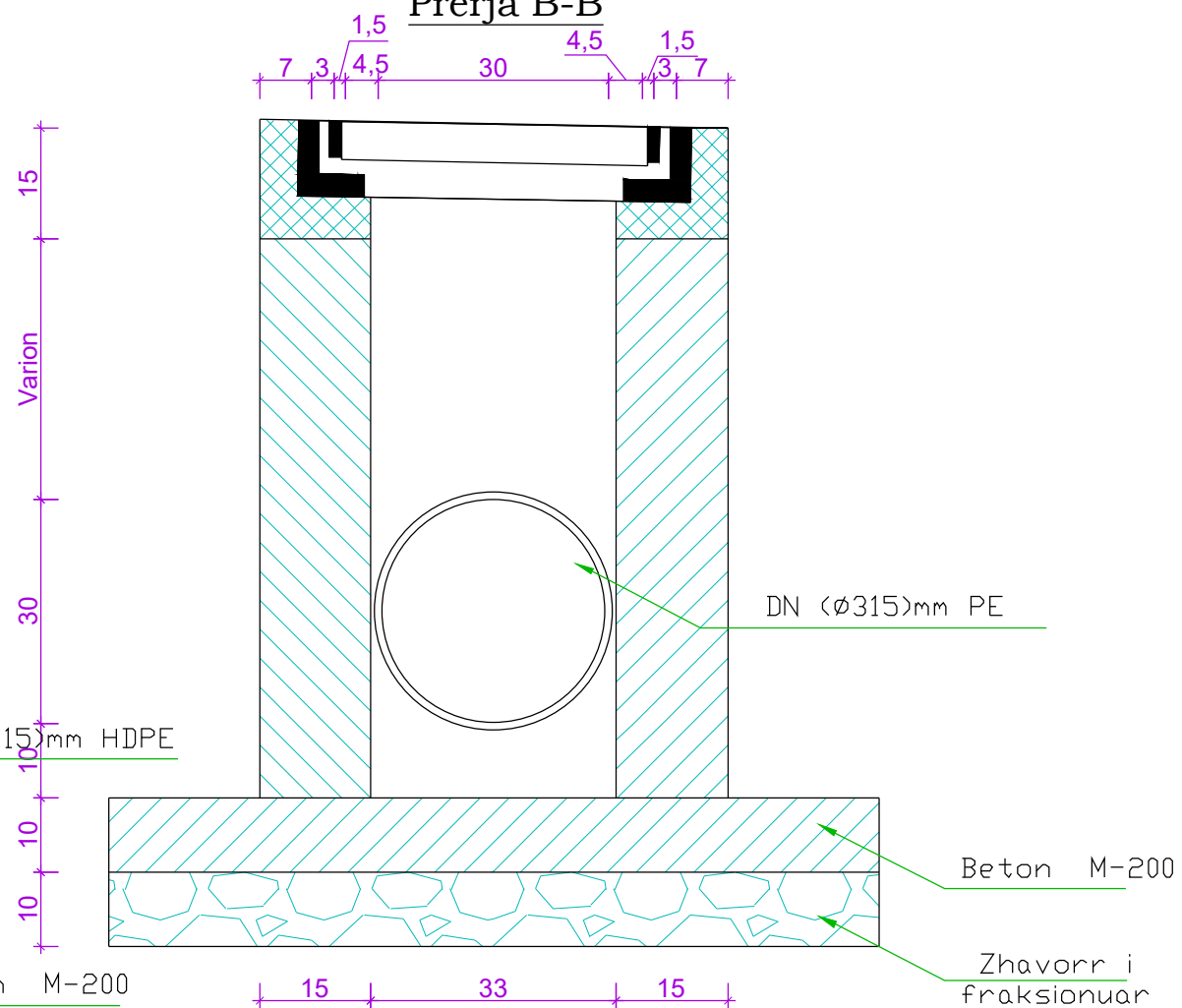

**SHËNIME :**

- 1.Muret e pusetes do te jene beton M-200 dhe me trashesi 15cm.
- 2.Betoni qe do te perdoret per brezin duhet te jete M-200, ndersa betoni i ullikut dhe shtreses do te jete M-150.
- 3.Telajo e kapakut do te jete prej gize i inkastruar me brezin e betonit dhe i vendosur ne nivelin e mbaruar te rruges sipas projektit.
- 4.Fundi i tubit duhet te jete 10cm nga fundi i pusetes.
- 5.Diametri i tubit do te jete si ne planimetri.

Investitor:

**BASHKIA SHKODER**

Miratoi:

**KRYETAR  
VOLTANA ADEMI**

Vula

RIKONSTRUKSION RRUGA "MENDAFSHIT"

Titulli i Projektit

Faza **PROJEKT ZBATIMI**

Vula

Autor "NOVATECH STUDIO "SHPK"



ADMIN ING. EMIL NOVA

ING. NDERTIMI	Reshit BEDHIA
ING. NDERTIMI	Mimoza TOMCO
ARKITEKT	Gerda NOVA
ARKITEKT	Lorisa FERRO
ING. HIDROTEKNIK	Kostandin NOVA
ING. GJEOLGJIK	Antonina BAZHARI
ING. MEKANIK	Nikolias DOKU
ING. ELERTRIK	Marketa SHLLARU
ING. MEKANIK	Rubin KODRA

Vula

Titulli i Vizatimit

DETAJE PUSETA E UJRAVE TE SHIUT PER  
DN Ø250/Ø315 mm PE

Realizuar **2021** Shkalla **1:10**

Emërtimi i Fletës

**B1 - 04**



# PUSETE KONTROLLI TIP (1.0x1.0) NE TROTUAR SH 1:25

## PLANIMETRIA E Pusetes

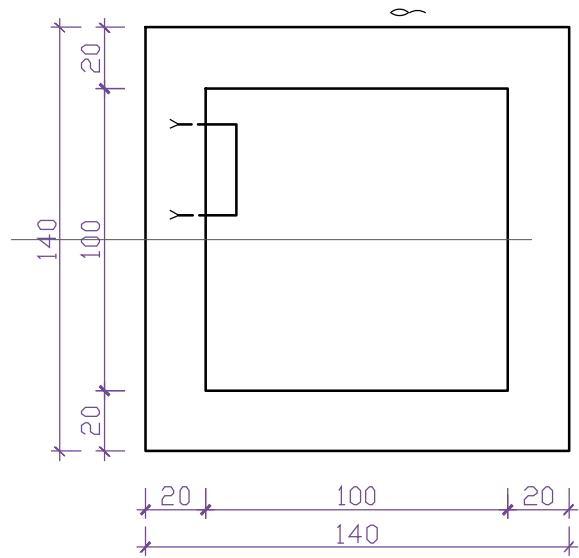

## PRERJA A - A

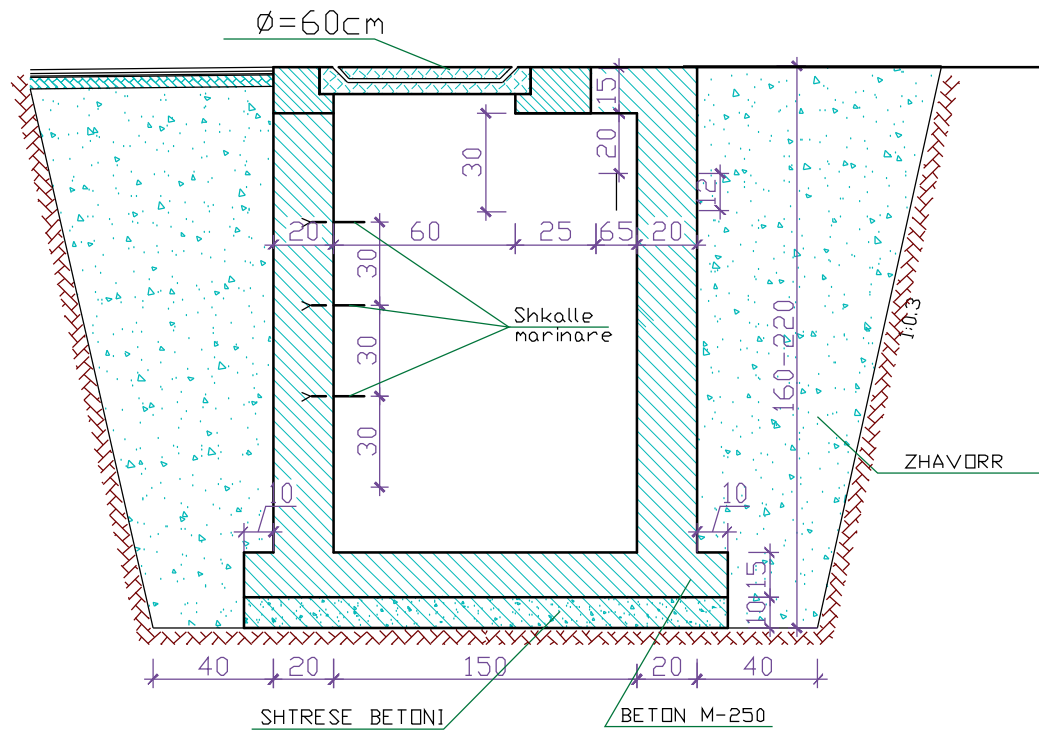

## PRERJA 1 - 1

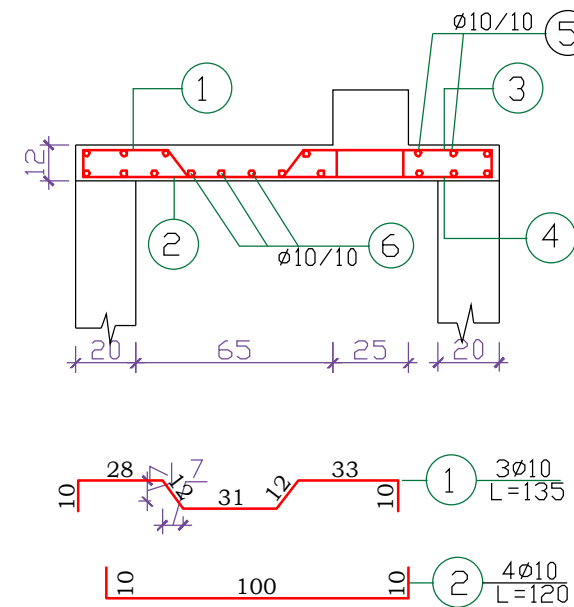

## MBULIMI I Pusetes

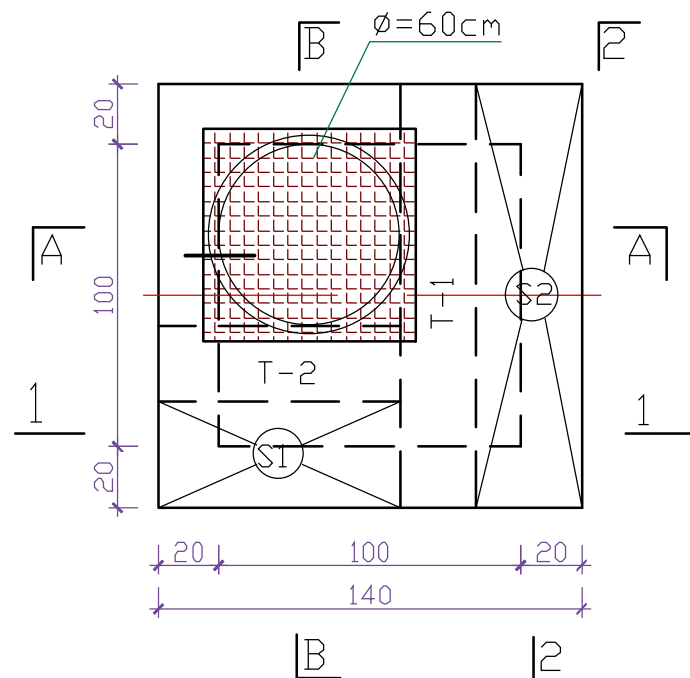

## TRAU "T-1"

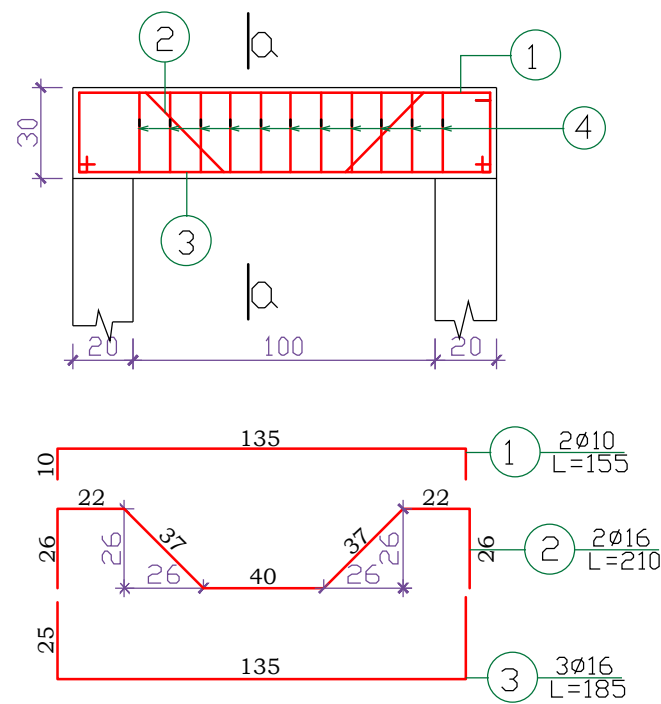

## PRERJA 2-2

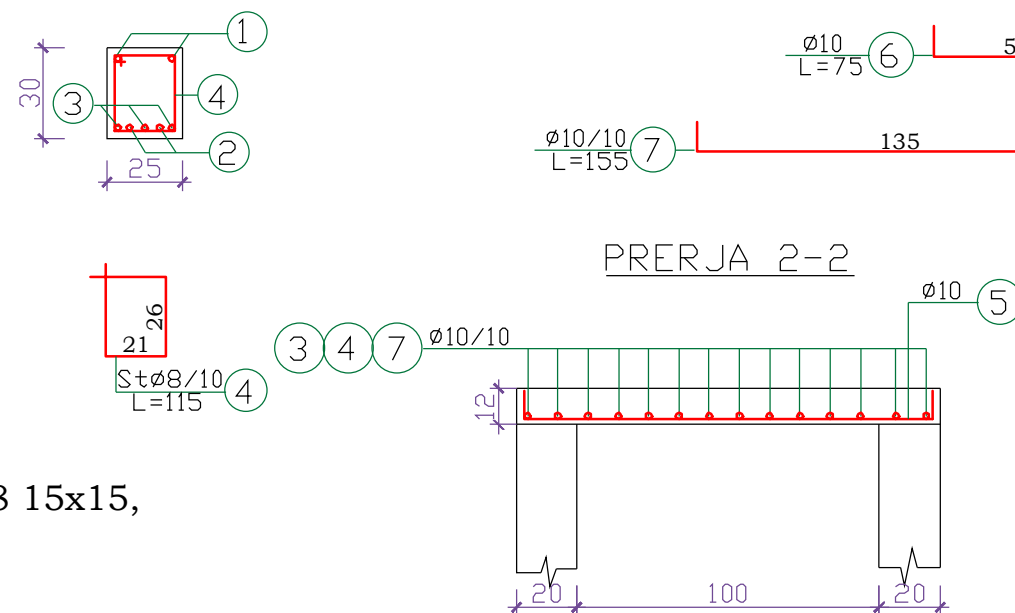

**SHENIM:**  
Puseta do realizohet me Beton M-250, Hekur Feb 44k.  
Muret anesore dhe dyshemeja te armohen konstruktivisht me dopio zgare Ø8 15x15, duke patur parasysh qe xhuntimi dhe ancorimi i shufrave te behet me min. 50diametra

Investitor:

**BASHKIA SHKODER**

Miratoi:

**KRYETAR  
VOLTANA ADEMI**

Vula

RIKONSTRUKSION RRUGA "MENDAFSHIT"

Titulli i Projektit

Faza **PROJEKT ZBATIMI**

Vula

Autor "NOVATECH STUDIO "SHPK"

**ADMIN ING. EMIL NOVA**

ING. NDERTIMI Reshit BEDHA  
ING. NDERTIMI Mimoza TOMCO  
ARKITEKT Gerda NOVA  
ARKITEKT Lorisa FERRO  
ING. HIDROTEKNIK Kostasid NOVA  
ING. GJEOLGJIK Antonia BAZHEKRI  
ING. MEKANIK Nikollas DOKU  
ING. ELERTRIK Marketin SHELARU  
ING. MEKANIK Rubin KODRA

Vula

Titulli i Vizatimit

**PUSETE KONTROLLI TIP (1.0x1.0)  
NE TROTUAR**

Realizuar 2021 Shkalla 1:25

Emërtimi i Fletës **B1 - 05**

## PROFILI GJATESOR I RRUGES

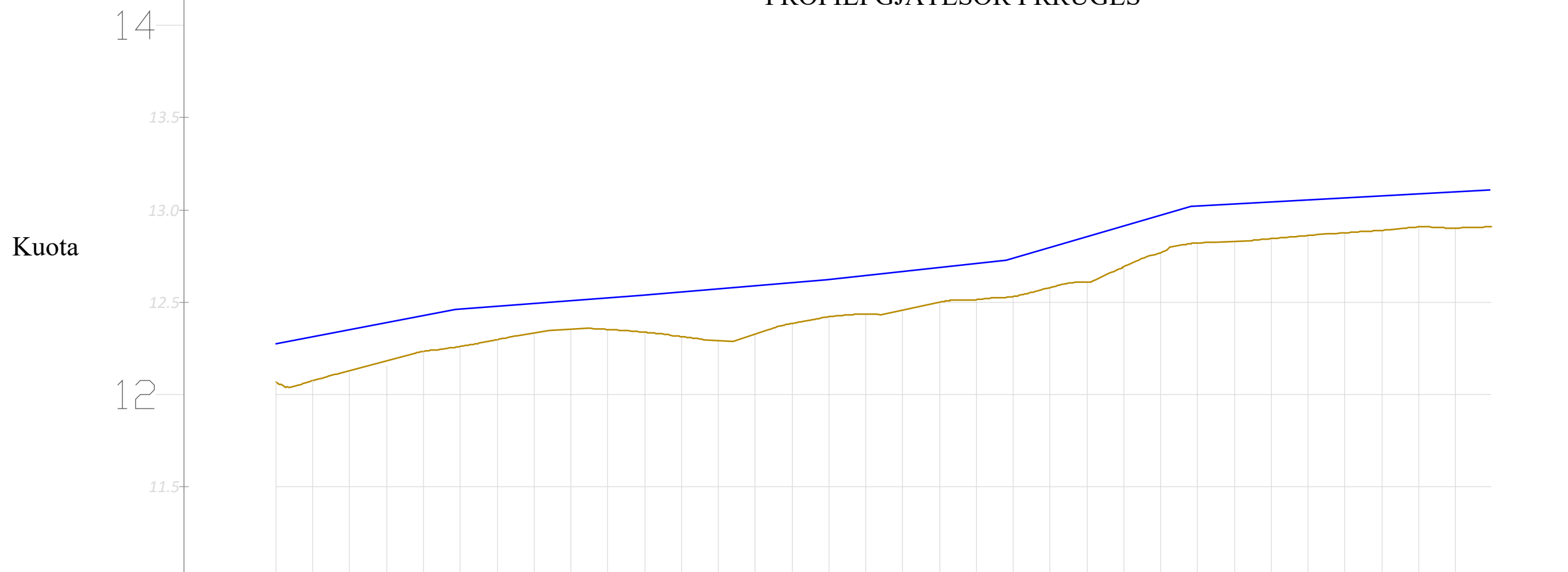

NR I PRERJES	1	2	3	4	5	6	7	8
	CS	CS	CS	CS	CS	CS	CS	CS
KUOTA TOKES	12.07	12.26	12.34	12.42	12.53	12.82	12.89	
KUOTA PROJEKTIT	12.27	12.46	12.54	12.62	12.74	13.02	13.08	
KUOTA PUNES	0.20	0.20	0.20	0.20	0.21	0.20	0.19	
DIST PJESORE	10.00	20.00	20.00	20.00	20.00	20.00	20.00	20.00
DIST PROGRESIVE	0+000	0+020	0+040	0+060	0+080	0+100	0+120	0+140
KILOMETRAZHI	0						0.1	

**Investitor:**  
**BASHKIA SHKODER**

**Miratoi:**  
**KRYETAR**  
**VOLTANA ADEMI**

**Vula**  
RIKONSTRUKSION RRUGA "MENDAFSHIT"

**Titulli i Projektit**

**Faza** **PROJEKT ZBATIMI**

**Vula**

**Autor** "NOVATECH STUDIO "SHPK"  
  
**ADMIN ING. EMIL NOVA**

ING. NDERTIMI Reshit BEDHA  
ING. NDERTIMI Mimoza TOMCO  
ARKITEKT Gerda NOVA  
ARKITEKT Lorisa FERRO  
ING. HIDROTEKNIK Kostasid NOVA  
ING. GJEOLGJIK Antonia BAZDARI  
ING. MEKANIK Nikollas DOKU  
ING. ELERTRIK Marketin SHLLARU  
ING. MEKANIK Rubin KODRA

**Vula**

**Titulli i Vizatimit**  
PROFILI GJATESOR I RRUGES

Realizuar **2021**      **Shkalla** **V.1:1000**  
 Emërtimi i Fletës      **H.1:50**

C1 - 01

## PROFILI GJATESOR KANALIZIMETE TE UJRAVE TE BARDHA

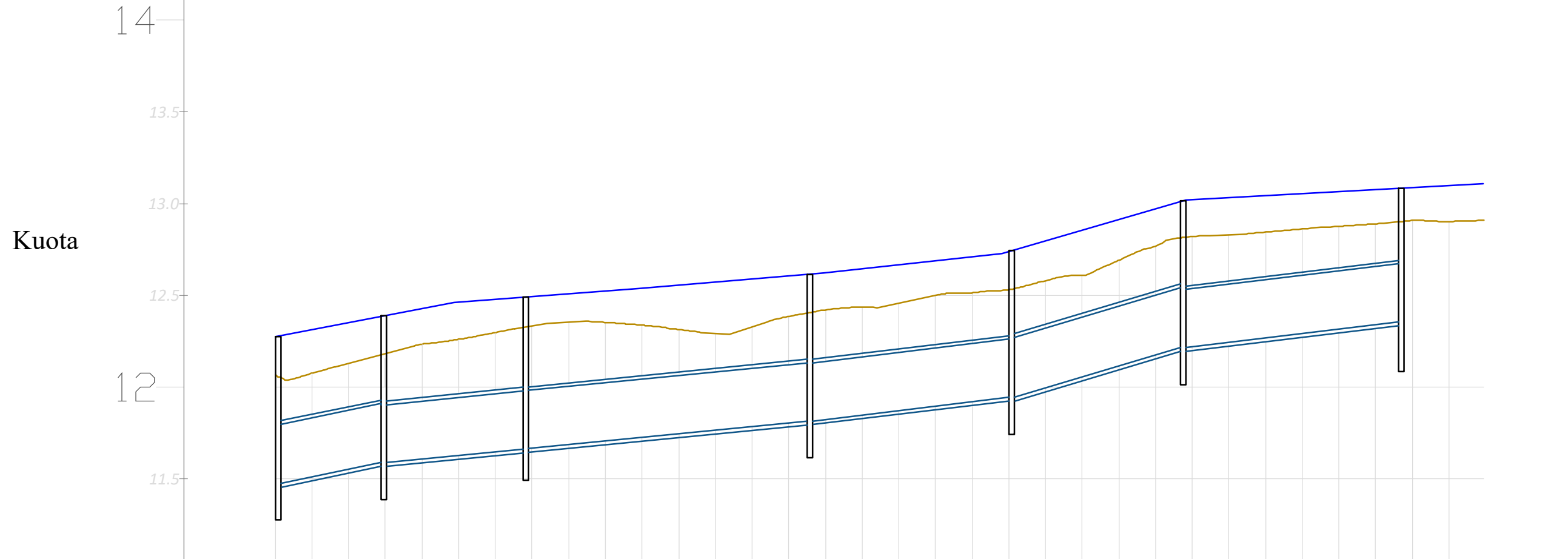

NR I PRERJES	1	2	3	4	5	6	7	8	
	CS	CS	CS	CS	CS	CS	CS	CS	
KUOTA TOKES	12.07	12.26	12.34	12.42	12.53	12.82	12.89		
KUOTA PROJEKTIT	12.27	12.46	12.54	12.62	12.74	13.02	13.08		
KUOTA PUNES	0.20	0.20	0.20	0.20	0.21	0.20	0.19		
DIST PJESORE		20.00	20.00	20.00	20.00	20.00	20.00	20.00	
DIST PROGRESIVE	0+000	0+020	0+040	0+060	0+080	0+100	0+120	0+140	
EL. HIDRAULIKE	11.46 i=1.0%	11.55 11.56 i=0.5%	11.66 11.67 i=0.5%	11.68 11.69 i=0.59%	11.91 11.92 i=1.43%	12.18 12.19 i=0.6%	12.33 12.34		
KILOMETRAZHI	0							0.1	

**Investitor:**  
**BASHKIA SHKODER**

**Miratoi:**  
**KRYETAR**  
**VOLTANA ADEMI**

**Vula**  
RIKONSTRUKSION RRUGA "MENDAFSHIT"

**Titulli i Projektit**

**Faza** **PROJEKT ZBATIMI**

**Vula**

**Autor** "NOVATECH STUDIO "SHPK"  
  
**ADMIN ING. EMIL NOVA**

ING. NDERTIMI	Reshit BEDHIA
ING. NDERTIMI	Mimoza TOMCO
ARKITEKT	Gerda NOVA
ARKITEKT	Lorisa FERRO
ING. HIDROTEKNIK	Kostandin NOVA
ING. GJELBEGJIK	Antonina BAZHARI
ING. MEKANIK	Nikollas DOKU
ING. ELERTRIK	Marketin SHLLARU
ING. MEKANIK	Rubin KODRA

**Vula**

**Titulli i Vizatimit**  
PROFILI GJATESOR KANALIZIMETE  
TE UJRAVE TE BARDHA

Realizuar	2021	Shkalla	V.1:1000
Emërtimi i Fletës		H.1:50	

**C1 - 02**

## PROFILI GJATESOR KANALIZIMETE TE UJRAVE TE ZEZA

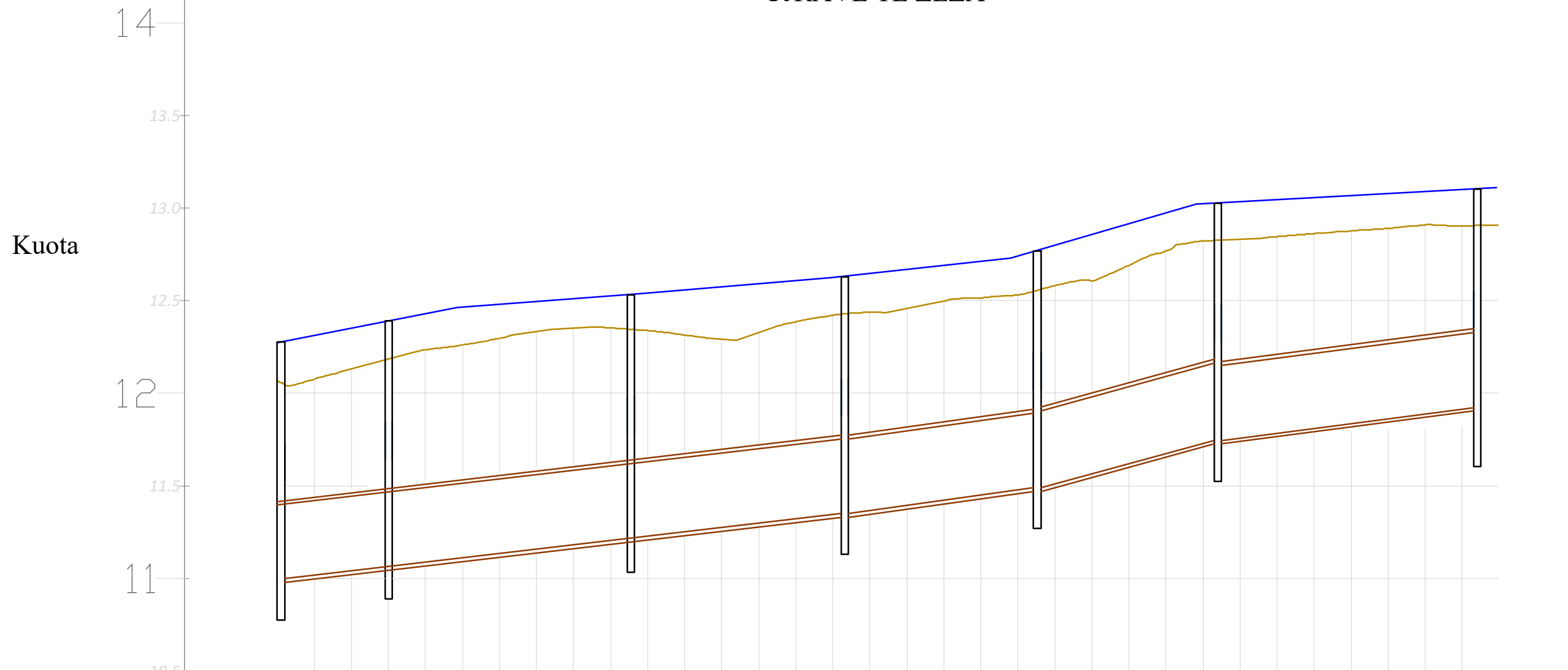

NR I PRERJES	1	2	3	4	5	6	7	8
KUOTA TOKES	12.07	12.26	12.34	12.42	12.53	12.82	12.89	
KUOTA PROJEKTIT	12.27	12.46	12.54	12.62	12.74	13.02	13.08	
KUOTA PUNES	0.20	0.20	0.20	0.20	0.21	0.20	0.19	
DIST PJESORE	10.00	20.00	20.00	20.00	20.00	20.00	20.00	20.00
DIST PROGRESIVE	0+000	0+020	0+040	0+060	0+080	0+100	0+120	0+140
EL. HIDRAULIKE	10.97 i=1.0%	11.06 11.07 i=0.55%	11.22 11.23 i=0.59%	11.31 11.32 i=0.59%	11.46 11.47 i=1.3%	11.72 11.73 i=0.65%	11.90 11.91	

**Investitor:**  
**BASHKIA SHKODER**

**Miratoi:**  
**KRYETAR  
VOLTANA ADEMI**

**Vula**  
RIKONSTRUKSION RRUGA "MENDAFSHIT"

**Titulli i Projektit**

**Faza** **PROJEKT ZBATIMI**

**Vula**

**Autor** "NOVATECH STUDIO "SHPK"  
  
**ADMIN ING. EMIL NOVA**

ING. NDERTIMI Reshit BEDHIA  
ING. NDERTIMI Mimoza TOMCO  
ARKITEKT Gerda NOVA  
ARKITEKT Lorisa FERRO  
ING. HIDROTEKNIK Kostasid NOVA  
ING. GJEJGJUK Antonia BAZHARI  
ING. MEKANIK Nikollas DOKU  
ING. ELERTRIK Marketin SHLLARU  
ING. MEKANIK Rubin KODRA

**Vula**

**Titulli i Vizatimit**  
PROFILI GJATESOR KANALIZIMETE  
TE UJRAVE TE ZEZA

Realizuar **2021** **Shkalla v.1:1000**  
Emërtimi i Fletës **H.1:50**



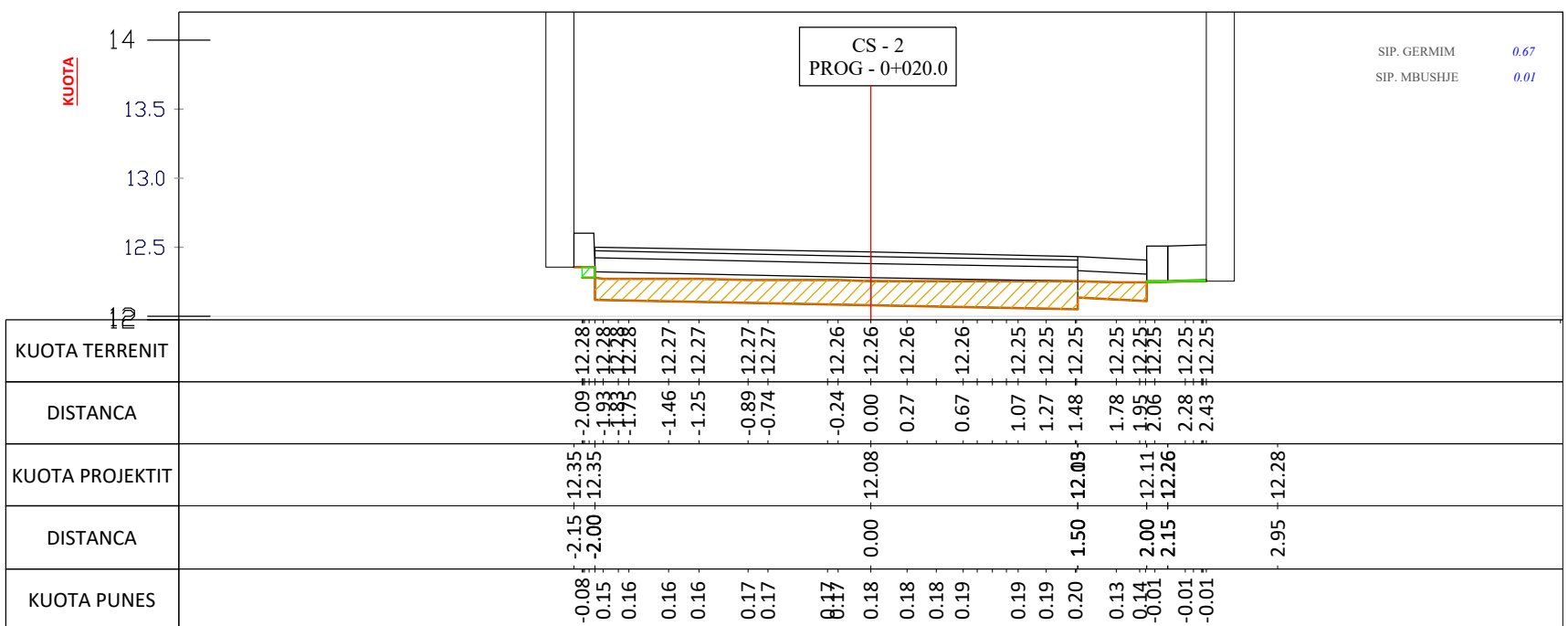
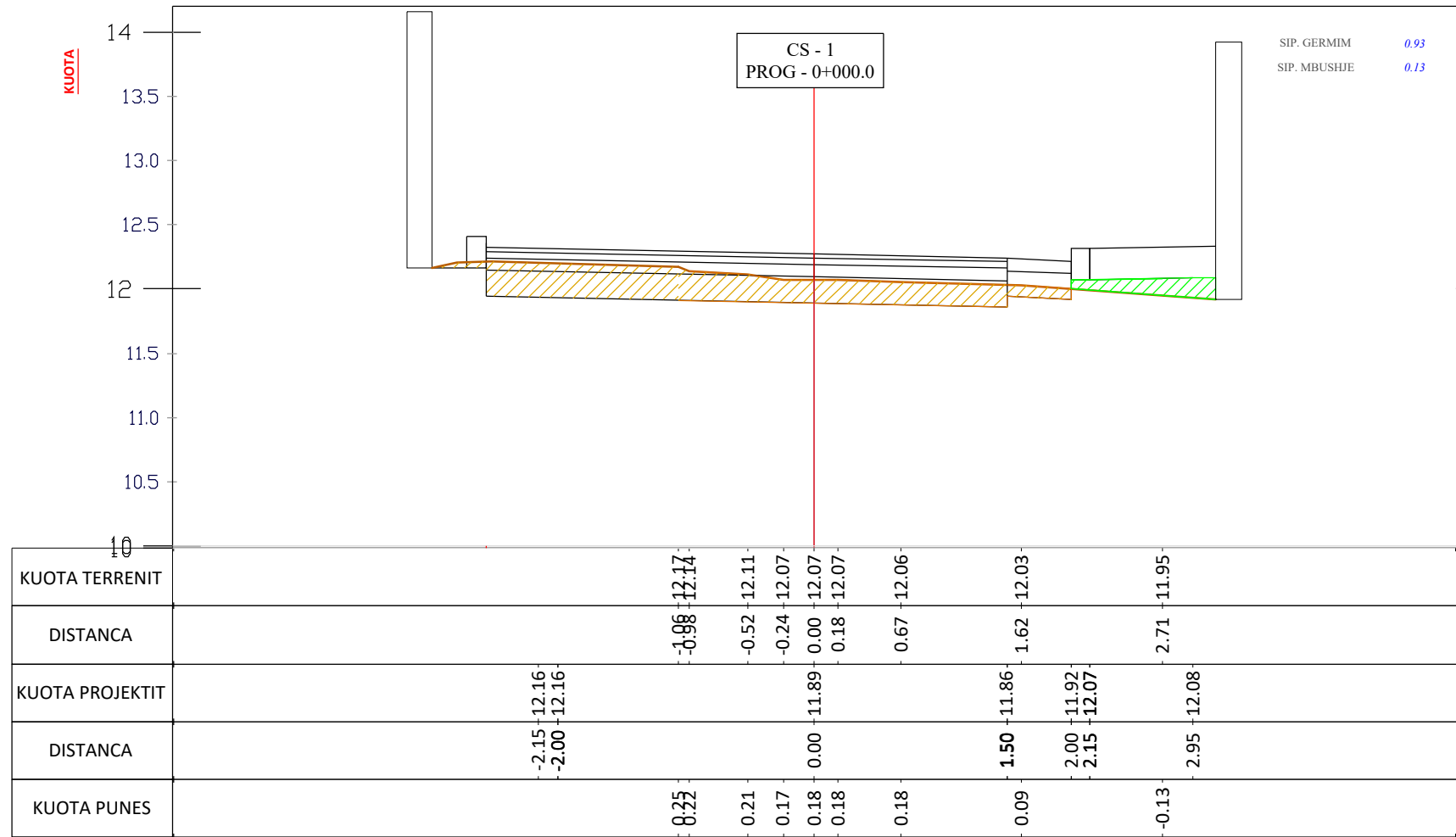

**Investitor:**  
**BASHKIA SHKODER**

**Miratoi:**  
**KRYETAR**  
**VOLTANA ADEMI**

**Vula**  
 RIKONSTRUKSION RRUGA "MENDAFSHIT"

**Titulli i Projektit**

**Faza** **PROJEKT ZBATIMI**

**Vula**

**Autor** "NOVATECH STUDIO "SHPK"  
  
**ADMIN ING. EMIL NOVA**

ING. NDERTIMI Reshit BEDHIA  
 ING. NDERTIMI Mimoza TOMCO  
 ARKITEKT Gerda NOVA  
 ARKITEKT Lorisa FERRO  
 ING. HIDROTEKNIK Kostasid NOVA  
 ING. GJERMEZGJIK Antonia BAZHEARI  
 ING. MEKANIK Nikollas DOKU  
 ING. ELERTRIK Marketin SHLLARU  
 ING. MEKANIK Rubin KODRA

**Vula**

**Titulli i Vizatimit**  
**PROFILAT TERTHORE**

Realizuar **2021** **Shkalla** **1:50**  
 Emërtimi i Fletës **D1 - 01**



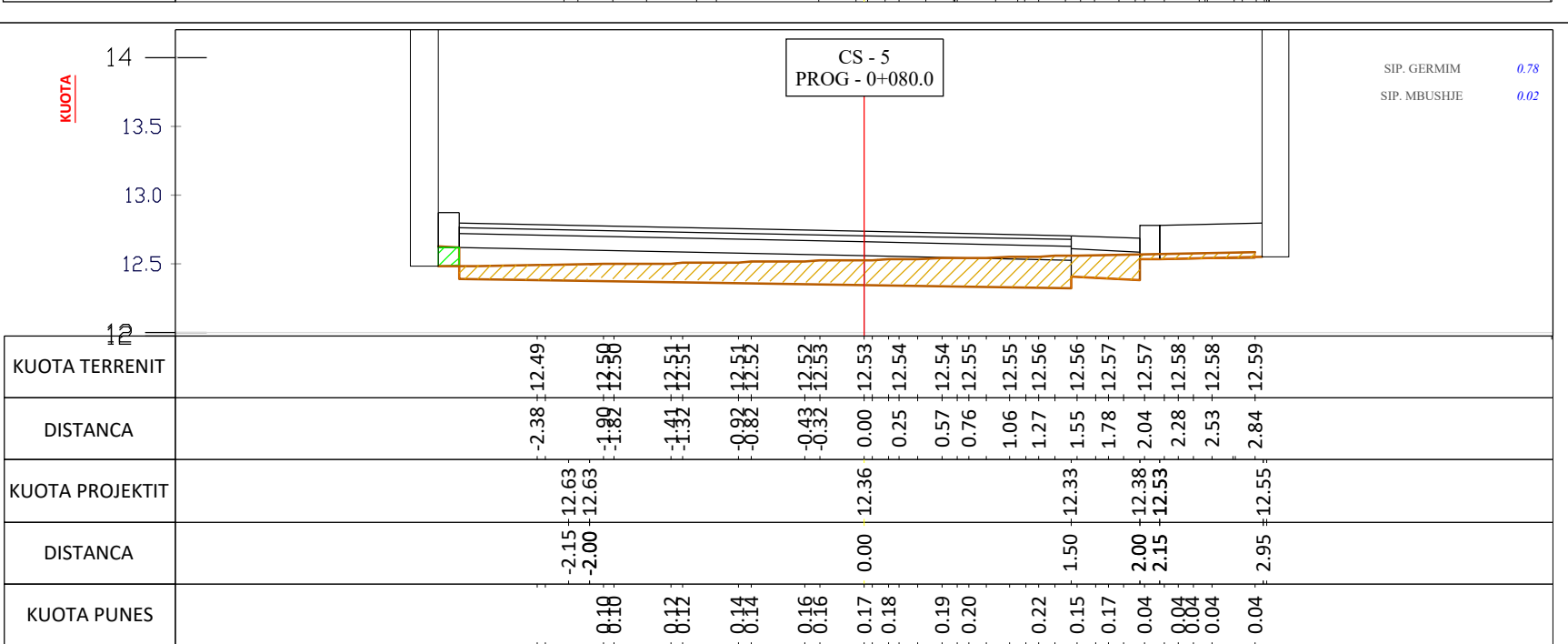
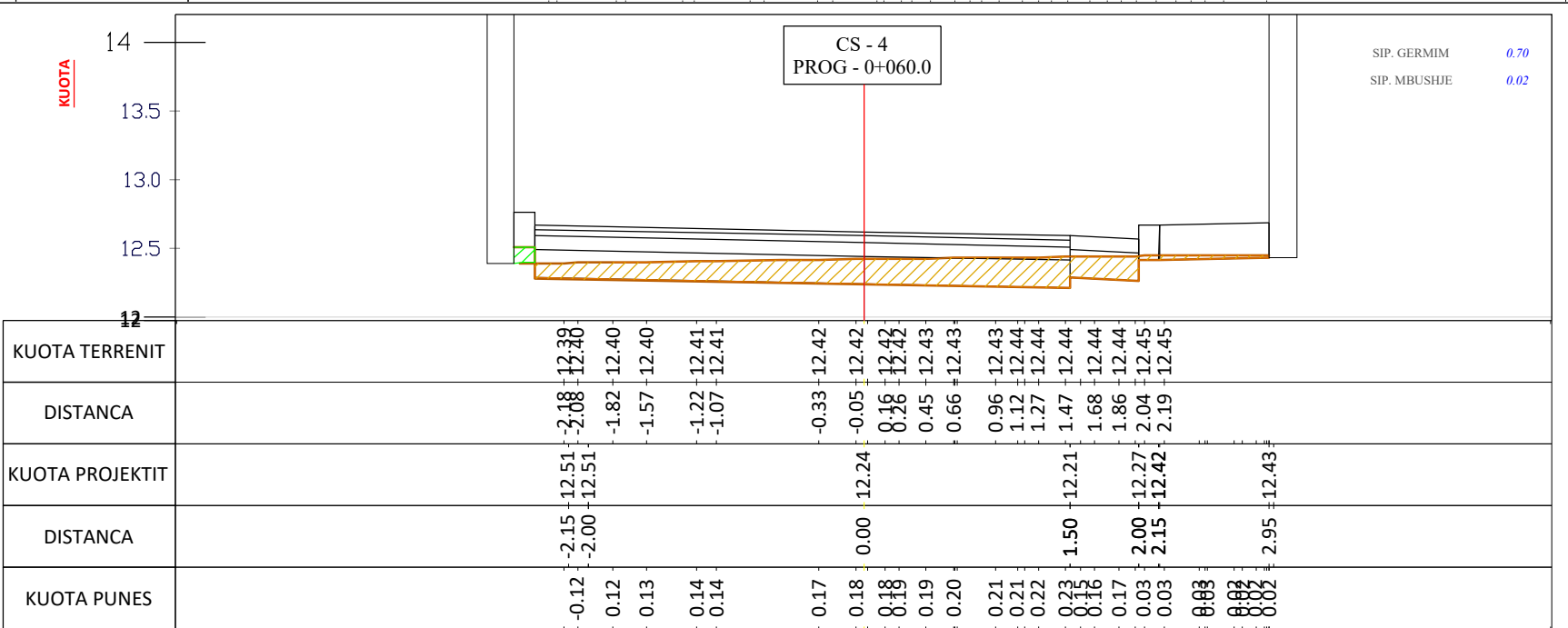
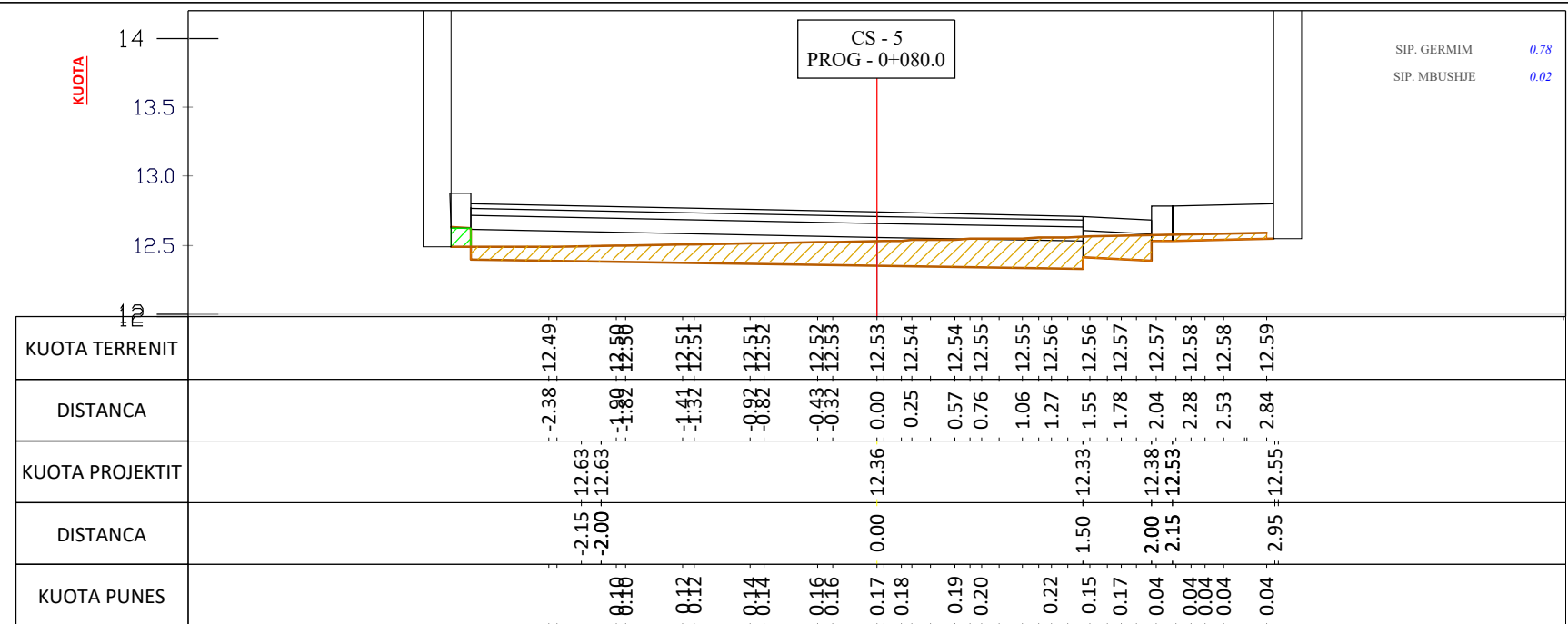

**Investitor:**  
**BASHKIA SHKODER**

**Miratoi:**  
**KRYETAR  
VOLTANA ADEMI**

**Vula**  
RIKONSTRUKSION RRUGA "MENDAFSHIT"

**Titulli i Projektit**

**Faza** **PROJEKT ZBATIMI**

**Vula**

**Autor** "NOVATECH STUDIO "SHPK"  
**ADMIN ING. EMIL NOVA**

ING. NDERTIMI	Reshit BEDHIA
ING. NDERTIMI	Mimoza TOMCO
ARKITEKT	Gerda NOVA
ARKITEKT	Lorisa FERRA
ING. HIDROTEKNIK	Kostandin NOVA
ING. GJELBEGJIK	Antonio BAZEKRI
ING. MEKANIK	Nikollas DOKU
ING. ELERTRIK	Marketin SHLLARU
ING. MEKANIK	Rubin KODRA

**Vula**

**Titulli i Vizatimit**  
**PROFILAT TERTHORE**

Realizuar	2021	Shkalla	1:50
-----------	------	---------	------

Emërtimi i Fletës **D1 - 03**

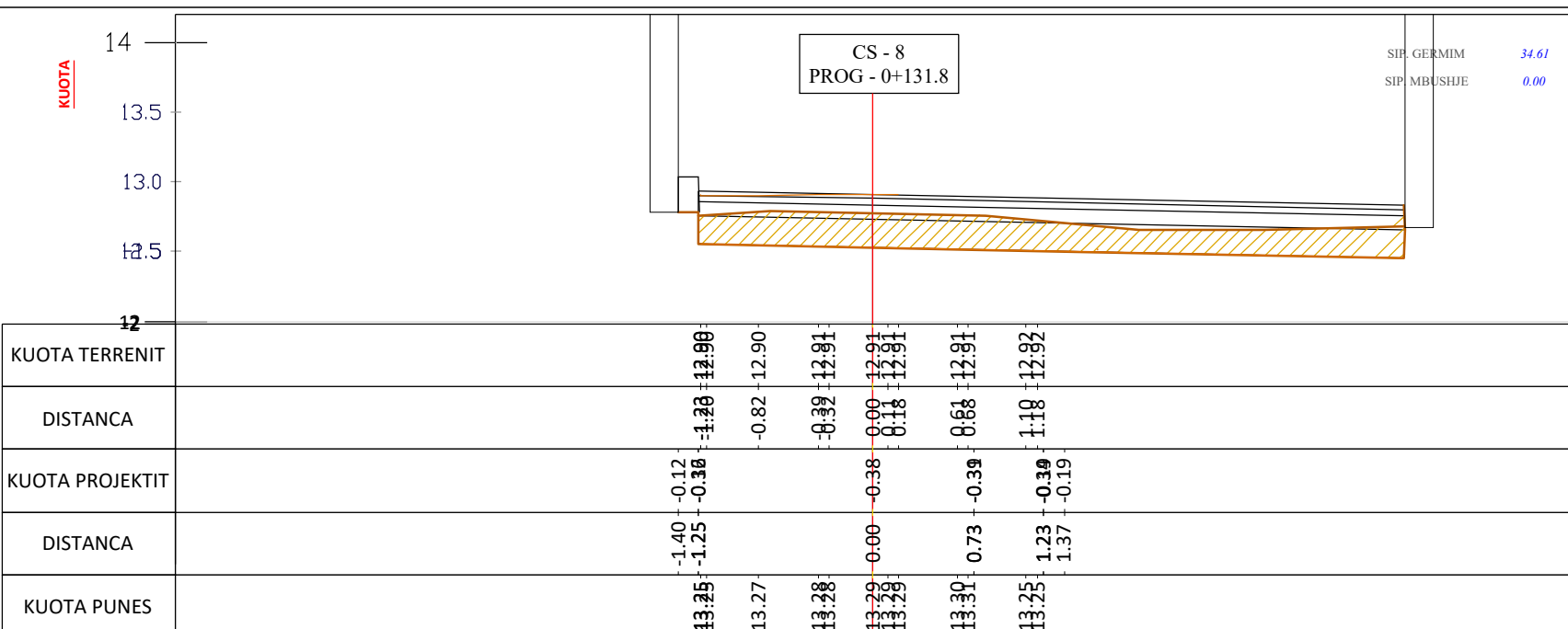
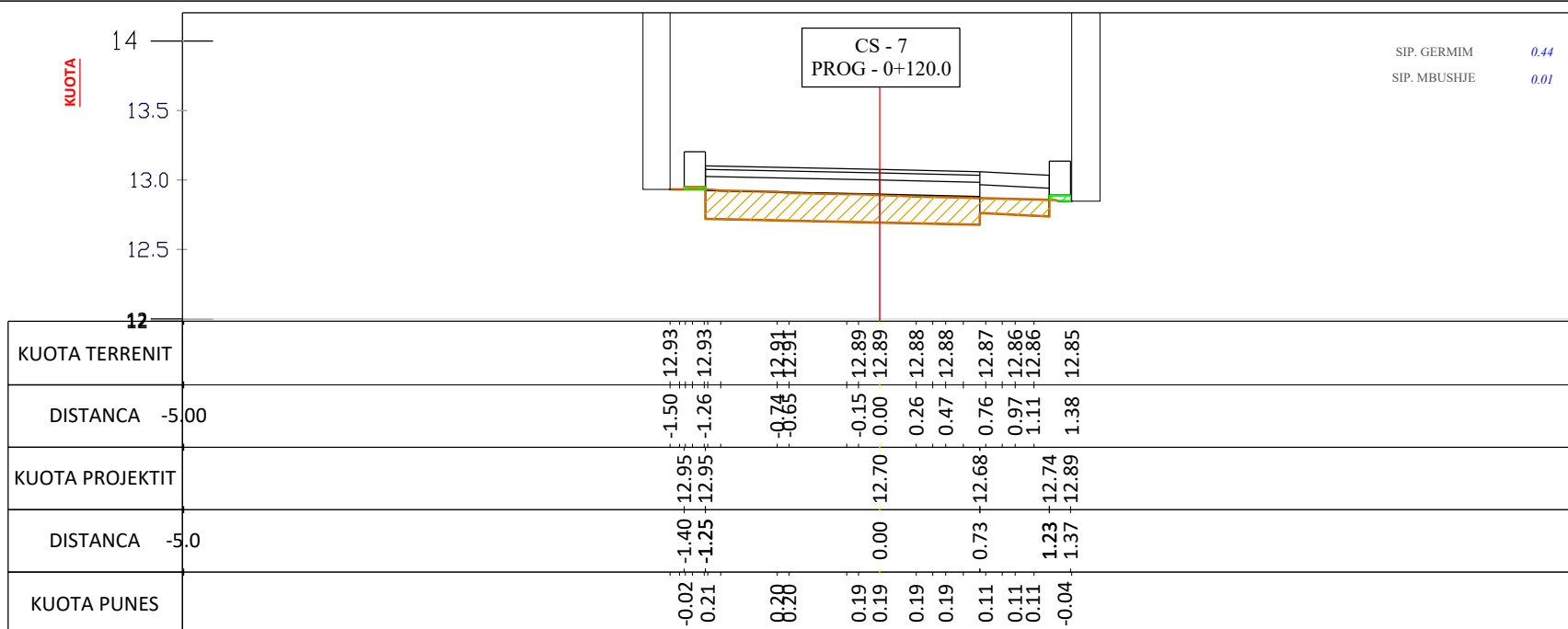
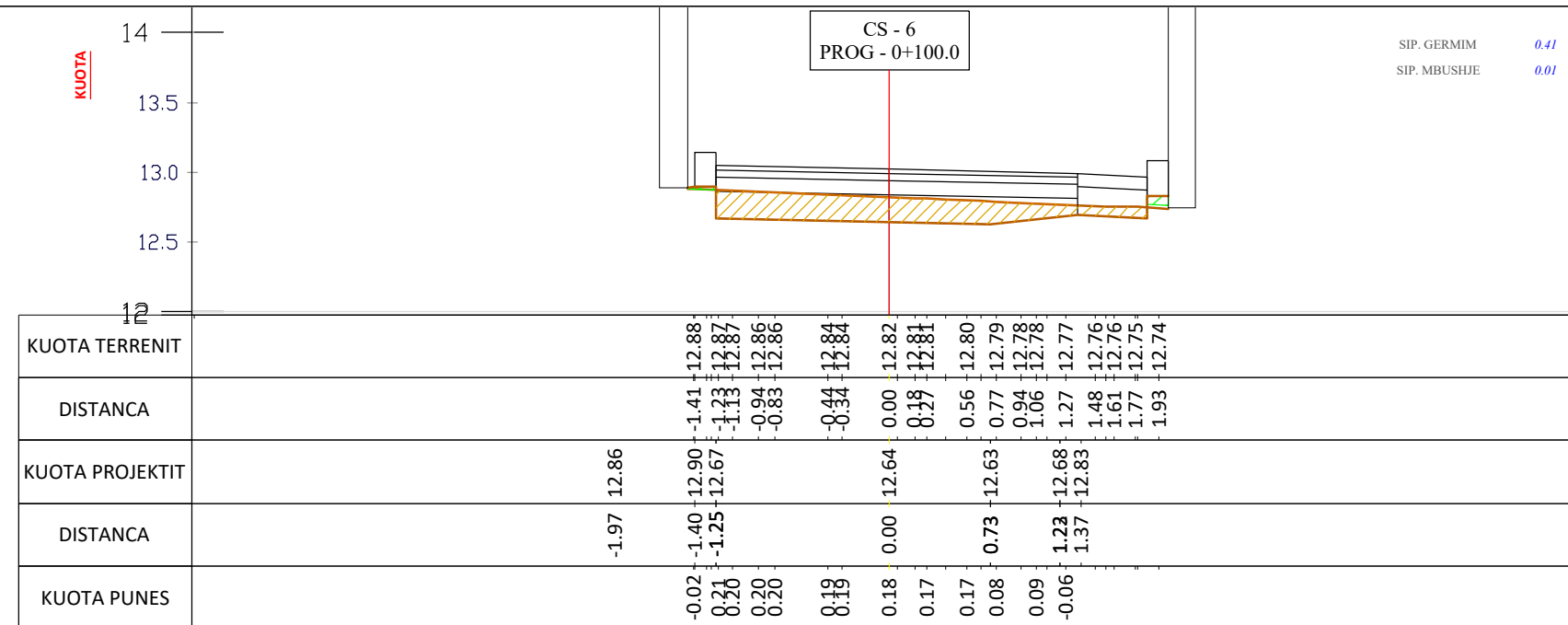

**Investitor:**  
**BASHKIA SHKODER**

**Miratoi:**  
**KRYETAR**  
**VOLTANA ADEMI**

**Vula**  
RIKONSTRUKSION RRUGA "MENDAFSHIT"

**Titulli i Projektit**

**Faza** **PROJEKT ZBATIMI**

**Vula**

**Autor** "NOVATECH STUDIO "SHPK"  
  
**ADMIN ING. EMIL NOVA**

ING. NDERTIMI Reshit BEDHIA  
ING. NDERTIMI Mimoza TOMCO  
ARKITEKT Gerda NOVA  
ARKITEKT Lorisa FERRA  
ING. HIDROTEKNIK Roslinda NOVA  
ING. GJELBORGJIK Antonia BAZHEARI  
ING. MEKANIK Nikollas DOKU  
ING. ELERTRIK Marketin SHLLARU  
ING. MEKANIK Rubin KODRA

**Vula**

**Titulli i Vizatimit**  
**PROFILAT TERTHORE**

Realizuar **2021** **Shkalla** **1:50**  
Emërtimi i Fletës **D1 - 04**