



MIRATOHET  
KRYETARI I BASHKISË  
Z. TONIN MARINAJ

BASHKIA MALESI E MADHE  
PROJEKT ZBATIMI

## **Sistemim Asfaltim rruga e Kishes Selce**

- 1– Hoorografia
- 2– Topografia e rruges
- 3– Planimetria e rruges
- 4– Profili gjatësor
- 5– Profilat tërthore
- 6– Profili tërthore tip

PROJEKTOI:  
"LENI-ING" SH.P.K

TIRANË 2023



MBARIMI I  
RRUGES

FILLIMI I  
RRUGES

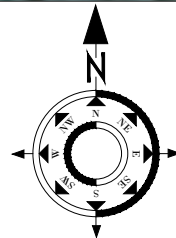

Porositi : BASHKIA MALESI E MADHE	Projektoi: "LENI-ING" sh.p.k Liçense: N.2969 ADMINISTRATOR Nikoll PALUCA Adresa: Rr. Uran Pano, Pallati 12 kat, Kati 2 Mobile: 0682042270 Email: leni-ing@hotmail.com	Objekti: <b>Sistemim Asfaltim rruga e Kishes Selce</b>	
	Emërtimi i Fletës: <b>HOOROGRAFIA</b>	Shkalla: <b>Sh 1:500</b>	Faza: <b>Projekt – Zbatim</b> Tiranë 2023 HORO



MIRATOHET  
KRYETARI I BASHKISË  
Z. TONIN MARINAJ

BASHKIA MALESI E MADHE  
PROJEKT ZBATIMI

## **Sistemim Asfaltim rruga e Kishes Selce**

- 1– Hoorografia
- 2– Topografia e rruges
- 3– Planimetria e rruges
- 4– Profili gjatësor
- 5– Profilat tërthore
- 6– Profili tërthore tip

PROJEKTOI:  
"LENI-ING" SH.P.K

TIRANË 2023

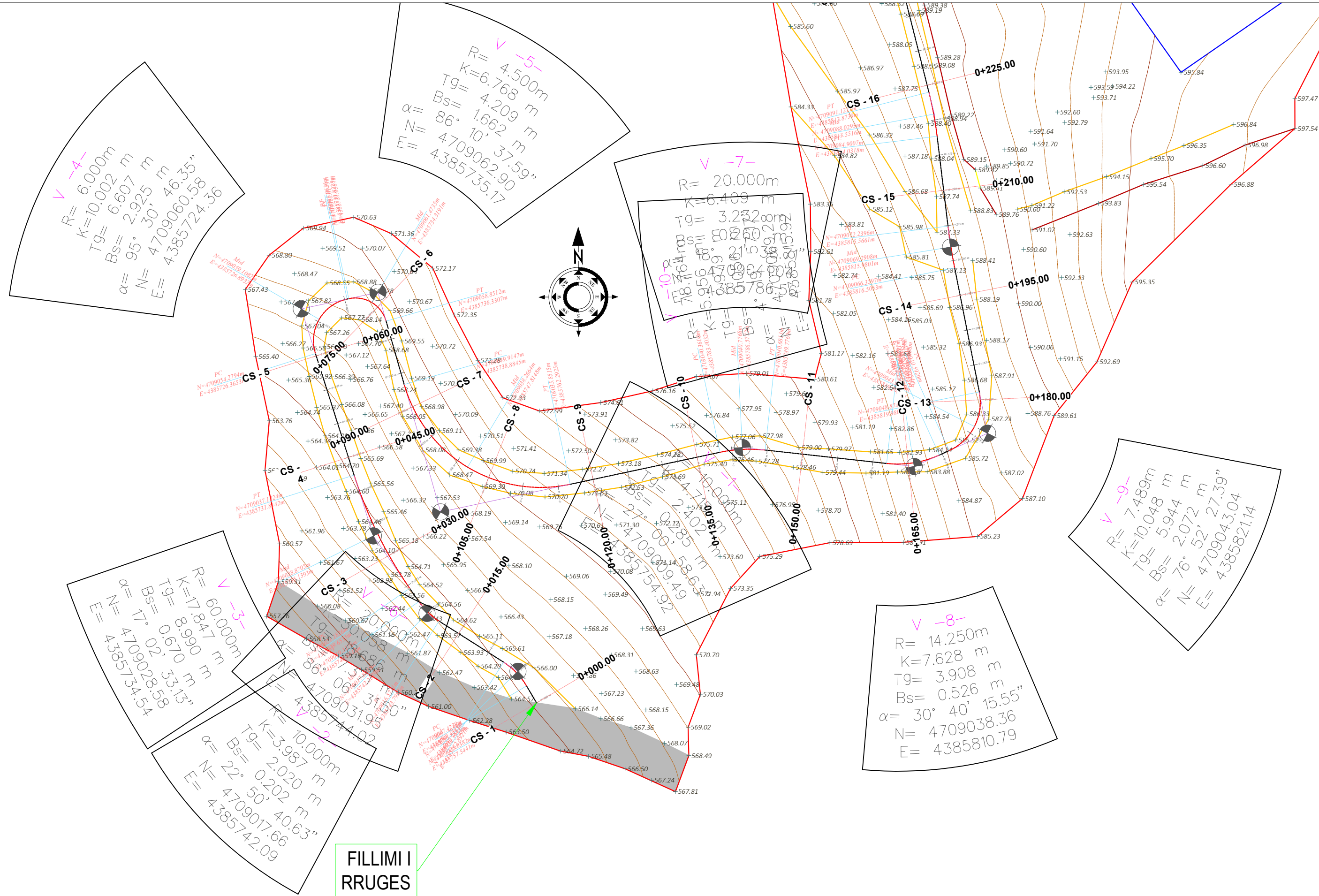

**FILLIMI I RRUGES**

- SHPJEGUES**
- 156.95 Pike detaje
  - 158.0 Izohipse
  - Objekt
  - Kanal Natyral
  - Rrethim
  - Mur Rrethues

Porositi :  
BASHKIA MALESI E MADHE

Projektoi:  
"LENI-ING" sh.p.k  
Liqense: N.2969  
ADMINISTRATOR Nikoll PALUCA  
Adresa: Rr. Uran Pano, Pallati 12 kat, Kati 2  
Mobile: 0682042270  
Email: leni-ing@hotmail.com

Objekti: Sistemim Asfaltim rruga e Kishes Selce		
Faza: Projekt – Zbatim		Emërtimi i Fletës: TOPOGRAFIJA E RRUGES
Shkalla: Sh 1:500	Tiranë 2023	Topo

**MBARIMI I RRUGES**

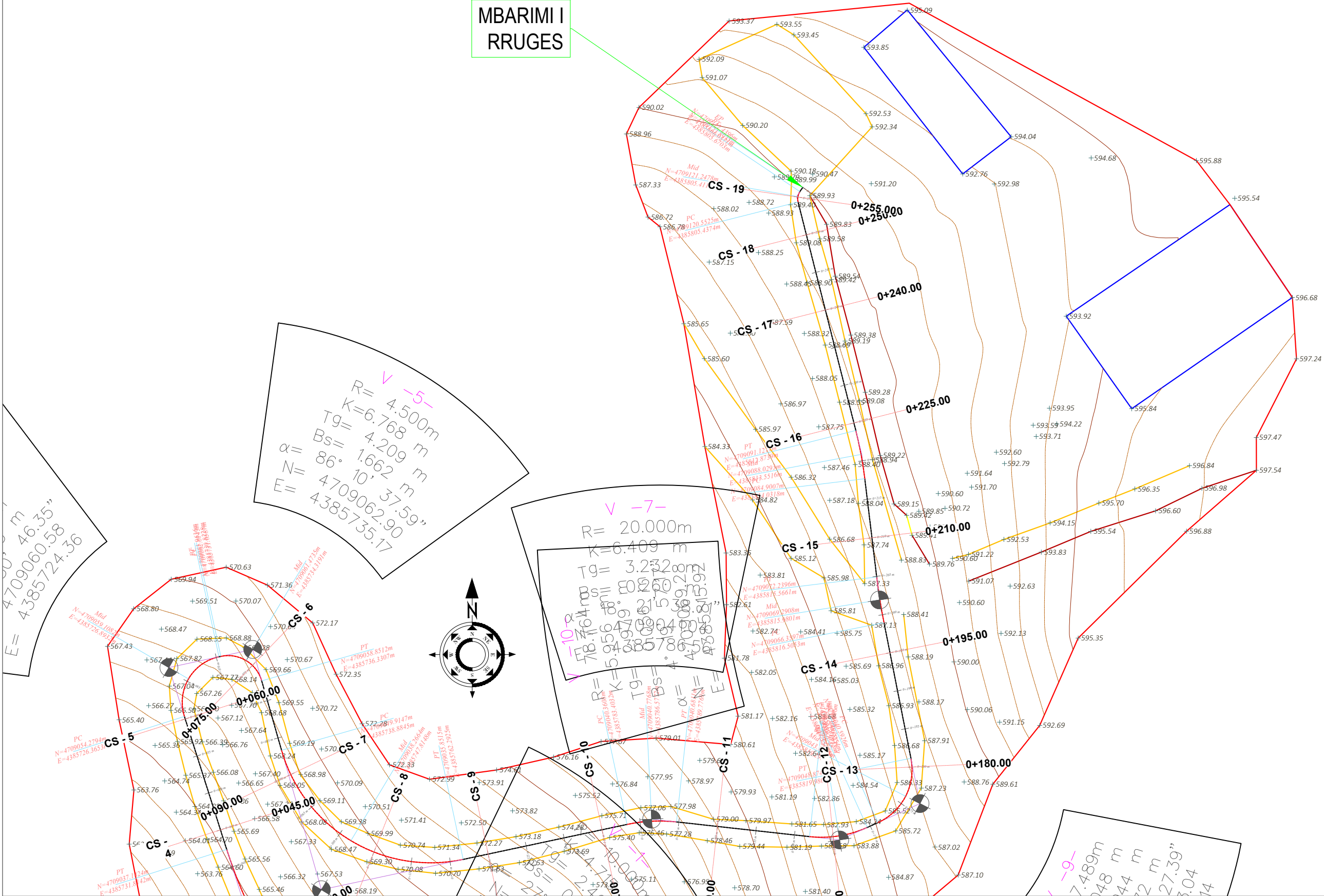

$R = 4.500\text{m}$   
 $K = 6.768\text{m}$   
 $Tg = 4.209\text{m}$   
 $Bs = 1.662\text{m}$   
 $\alpha = 86^\circ 10' 37.59''$   
 $N = 4709062.90$   
 $E = 4385735.17$

$R = 20.000\text{m}$   
 $K = 6.409\text{m}$   
 $Tg = 3.252\text{m}$   
 $Bs = 4.021\text{m}$   
 $\alpha = 45^\circ 09' 13.92''$   
 $N = 4709058.8512\text{m}$   
 $E = 4385736.3307\text{m}$

$R = 14.89\text{m}$   
 $K = 2.48\text{m}$   
 $Tg = 1.44\text{m}$   
 $Bs = 0.27\text{m}$   
 $\alpha = 27.39^\circ$   
 $N = 4709037.1134\text{m}$   
 $E = 4385731.3142\text{m}$

**SHPJEGUES**

- 156.95 Pike detaje
- 158.0 Izohipse
- Objekt
- Kanal Natyral
- Rrethim
- Mur Rrethues

Porositi :  
**BASHKIA MALESI E MADHE**

Projektoi:  
**"LENI-ING" sh.p.k**  
 Liçense: N.2969  
 ADMINISTRATOR **Nikoll PALUCA**  
 Adresa: Rr. Uran Pano, Pallati 12 kat, Kati 2  
 Mobile: 0682042270  
 Email: leni-ing@hotmail.com

Objekti: <b>Sistemim Asfaltim rruga e Kishes Selce</b>		
Faza:		Projekt – Zbatim
Emërtimi i Fletës:	Shkalla:	Tiranë 2023
<b>TOPOGRAFIJA E RRUGES</b>	<b>Sh 1:500</b>	Topo (2)



MIRATOHET  
KRYETARI I BASHKISË  
Z. TONIN MARINAJ

BASHKIA MALESI E MADHE  
PROJEKT ZBATIMI

## **Sistemim Asfaltim rruga e Kishes Selce**

- 1– Hoorografia
- 2– Topografia e rruges
- 3– Planimetria e rruges
- 4– Profili gjatësor
- 5– Profilat tërthore
- 6– Profili tërthore tip

PROJEKTOI:  
"LENI-ING" SH.P.K

TIRANË 2023

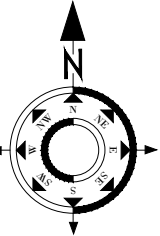
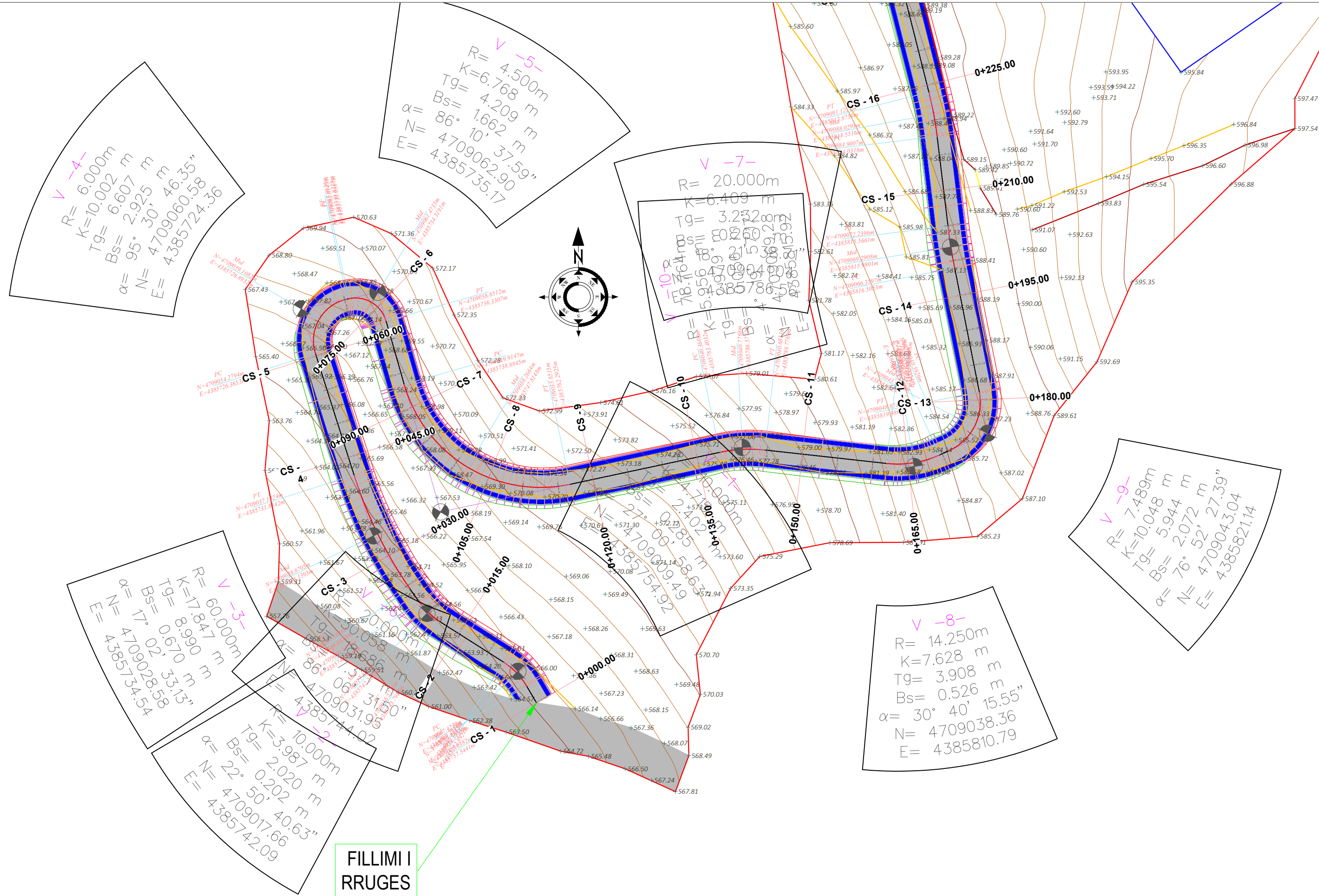

FILLIMI I  
RRUGES

- SHPJEGUES**
- 156.95 Pike detaje
  - 158.0 Izohipse
  - Objekt
  - Kanal Natyral
  - Rrethim
  - Mur Rrethues

Porositi :  
BASHKIA  
MALESI E  
MADHE

Projektoi:  
"LENI-ING" sh.p.k  
Liçense: N.2969  
ADMINISTRATOR Nikoll PALUCA  
Adresa: Rr. Uran Pano, Pallati 12 kat, Kati 2  
Mobile: 0682042270  
Email: leni-ing@hotmail.com

Objekti: Sistemim Asfaltim rruga e Kishes Selce		
Faza: Projekt – Zbatim		Emërtimi i Fletës: PLANIMETRIA E RRUGES
Shkalla: Sh 1:500	Tiranë 2023	PL

**MBARIMI I RRUGES**

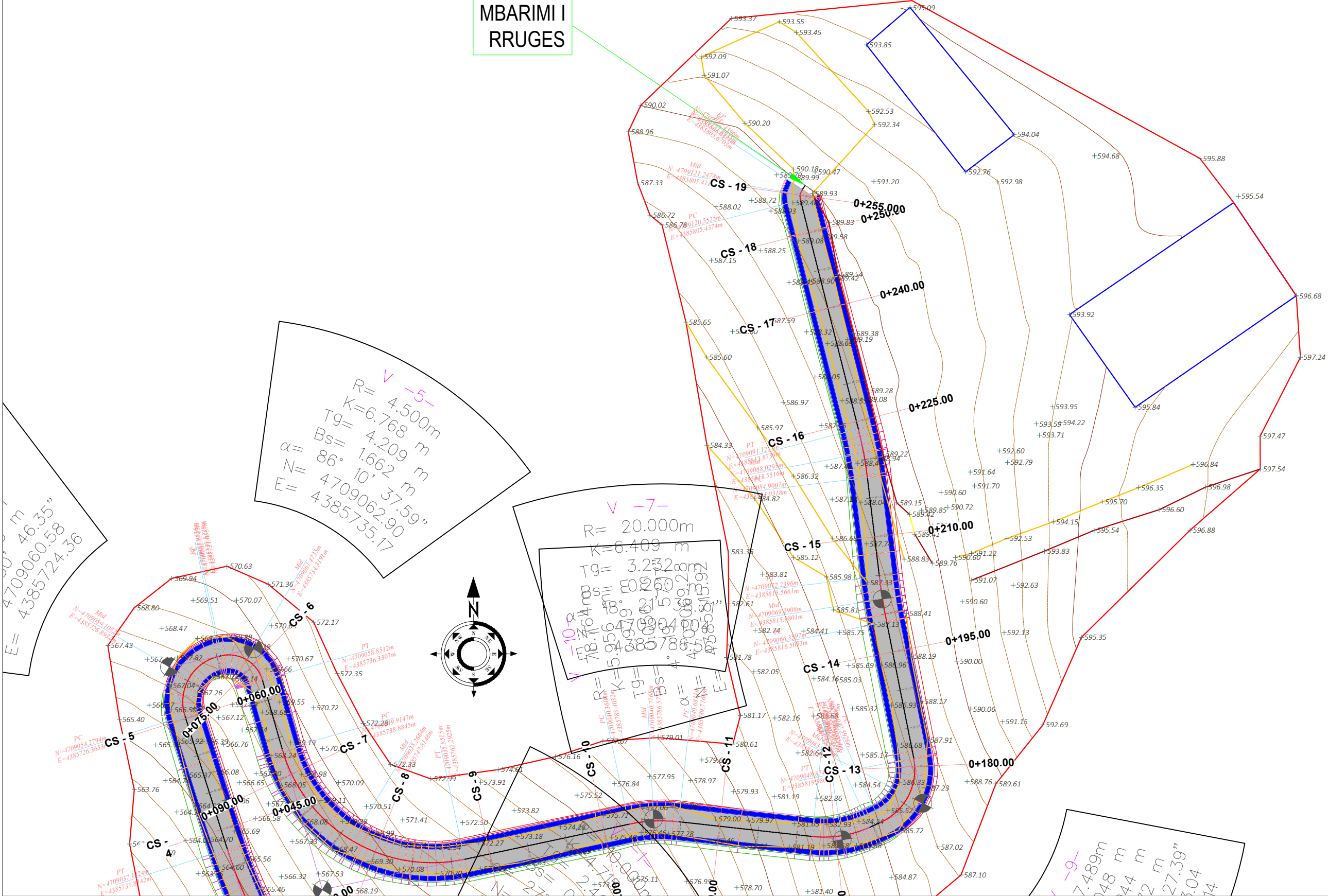

$R = 4.500\text{m}$   
 $K = 6.768\text{ m}$   
 $Tg = 4.209\text{ m}$   
 $Bs = 1.662\text{ m}$   
 $\alpha = 86^\circ 10' 37.59''$   
 $N = 4709062.90$   
 $E = 4385735.17$

$R = 20.000\text{m}$   
 $K = 6.409\text{ m}$   
 $Tg = 3.252\text{m}$   
 $Bs = 1.021\text{ m}$   
 $\alpha = 4^\circ 09' 06.92''$   
 $N = 4709058.851\text{m}$   
 $E = 4385736.3307\text{m}$

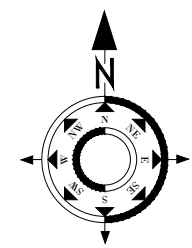

**SHPJEGUES**

- 156.95 Pike detaje
- 158.0 Izohipse
- Objekt
- Kanal Natyral
- Rrethim
- Mur Rrethues

Porositi :  
**BASHKIA MALESI E MADHE**

Projektoi:  
**"LENI-ING" sh.p.k**  
 Liçense: N.2969  
 ADMINISTRATOR **Nikoll PALUCA**  
 Adresa: Rr. Uran Pano, Pallati 12 kat, Kati 2  
 Mobile: 0682042270  
 Email: leni-ing@hotmail.com

Objekti: <b>Sistemim Asfaltim rruga e Kishes Selce</b>		
Faza:		Projekt – Zbatim
Emërtimi i Fletës:	Shkalla:	Tiranë 2023
<b>PLANIMETRIA E RRUGES</b>	<b>Sh 1:500</b>	PL 2





MIRATOHET  
KRYETARI I BASHKISË  
Z. TONIN MARINAJ

BASHKIA MALESI E MADHE  
PROJEKT ZBATIMI

## **Sistemim Asfaltim rruga e Kishes Selce**

- 1– Hoorografia
- 2– Topografia e rruges
- 3– Planimetria e rruges
- 4– Profili gjatësor
- 5– Profilat tërthore
- 6– Profili tërthore tip

PROJEKTOI:  
"LENI-ING" SH.P.K

TIRANË 2023

PROFILI GJATESOR  
Aksi i Rruges 1  
SH\_H - 1:1000  
SH\_V - 1:500

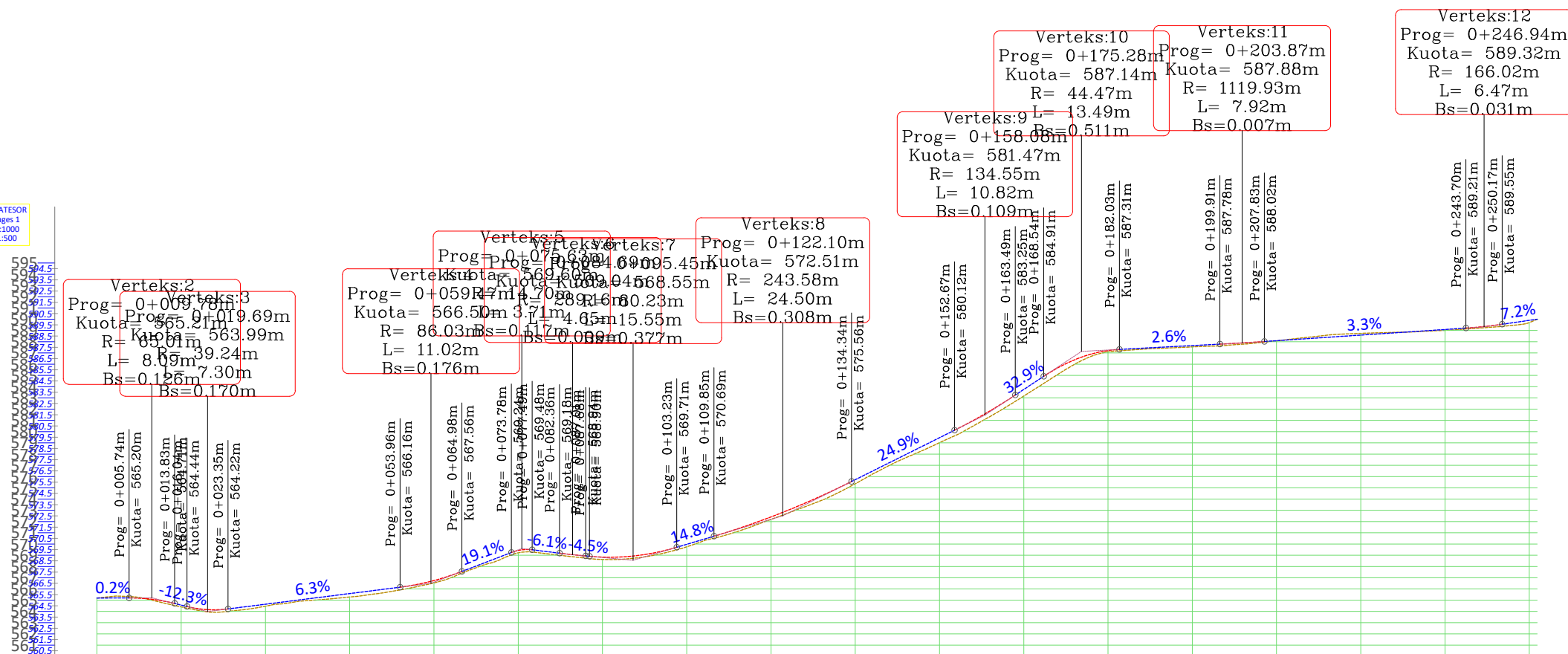

NR I PRERJES	CS - 1	CS - 2	CS - 3	CS - 4	CS - 5	CS - 6	CS - 7	CS - 8	CS - 9	CS - 10	CS - 11	CS - 12	CS - 13	CS - 14	CS - 15	CS - 16	CS - 17	CS - 18	CS - 19
DIST. PJESORE		15.0 m	15.0 m	15.0 m	15.0 m	15.0 m	15.0 m	15.0 m	15.0 m	15.0 m	15.0 m	15.0 m	15.0 m	15.0 m	15.0 m	15.0 m	10.0 m	5.0 m	
DIST. PROGRESSIVE	0+000	0+015	0+030	0+045	0+060	0+075	0+090	0+105	0+120	0+135	0+150	0+165	0+180	0+195	0+210	0+225	0+240	0+250	0+255
KUOTA TOKES																			
KUOTA PROJEKTTIT	-565.19	-564.41	-564.64	-565.28	-566.54	-569.22	-568.63	-569.75	-572.19	-575.36	-579.46	-583.16	-587.10	-587.65	-588.07	-588.59	-589.09	-589.54	-589.90
KUOTA PUNES	0.00	0.16	0.18	0.31	0.21	0.21	0.21	0.22	0.22	0.36	0.44	0.59	0.12	0.12	0.01	-0.15	0.08	0.18	0.20
GJEO. VERTIKALE		$R = 65.03$ $K = 8.09$	$R = 39.24$ $K = 3.39$	$L = 30.61$ $i = 6.32\%$	$R = 86.03$ $K = 11.02$	$R = 80.23$ $K = 10.05$	$R = 80.23$ $K = 10.05$	$R = 80.23$ $K = 10.05$	$R = 243.58$ $K = 24.50$	$L = 18.32$ $i = 24.90\%$	$R = 134.55$ $K = 10.82$	$R = 44.47$ $K = 13.49$	$L = 17.83$ $i = 2.62\%$	$R = 1119.93$ $K = 7.92$	$L = 35.87$ $i = 3.32\%$	$R = 166.02$ $K = 6.43$			
GJEO. HORIZONTALE	$\phi = 27^{\circ}00'59''$ $L = 17.42$ $R = 10.00$	$\phi = 22^{\circ}50'41''$ $L = 10.78$ $R = 10.00$	$\phi = 17^{\circ}02'33''$ $L = 17.85$ $R = 60.00$	$L = 17.98$	$\phi = 95^{\circ}30'44''$ $L = 10.60$ $R = 6.00$	$\phi = 103^{\circ}38'10''$ $L = 9.29$ $R = 4.50$	$\phi = 86^{\circ}06'32''$ $L = 30.06$ $R = 20.00$	$L = 21.59$	$\phi = 18^{\circ}21'39''$ $L = 6.41$ $R = 20.00$	$L = 17.24$	$\phi = 30^{\circ}40'16''$ $L = 7.63$ $R = 14.25$	$\phi = 76^{\circ}52'27''$ $L = 10.05$ $R = 7.49$	$L = 17.83$	$\phi = 4^{\circ}19'57''$ $L = 5.96$ $R = 78.76$	$\phi = 7^{\circ}16'15''$ $L = 6.33$ $R = 49.89$	$L = 12.75$	$L = 30.36$	$\phi = 48^{\circ}03'59''$ $L = 11.49$ $R = 11.67$	
KILOMETRAZHI	0.01			0.05			0.10			0.15			0.20			0.25			0.28

Porositi :	Projektoi:	Objekti: <b>Sistemim Asfaltim rruga e Kishes Selce</b>	
BASHKIA MALESI E MADHE	"LENI-ING" sh.p.k Liçense: N.2969	Faza: Projekt – Zbatim	
	ADMINISTRATOR Nikoll PALUCA	Emërtimi i Fletës:	Tiranë 2023
	Adresa: Rr. Uran Pano, Pallati 12 kat, Kati 2 Mobile: 0682042270 Email: leni-ing@hotmail.com	PROFILI GJATESORE	PGJ
		Shkalla: 1:1000 1:500	



MIRATOHET  
KRYETARI I BASHKISË  
Z. TONIN MARINAJ

BASHKIA MALESI E MADHE  
PROJEKT ZBATIMI

## **Sistemim Asfaltim rruga e Kishes Selce**

- 1– Hoorografia
- 2– Topografia e rruges
- 3– Planimetria e rruges
- 4– Profili gjatësor
- 5– Profilat tërthore
- 6– Profili tërthore tip

PROJEKTOI:  
"LENI-ING" SH.P.K

TIRANË 2023

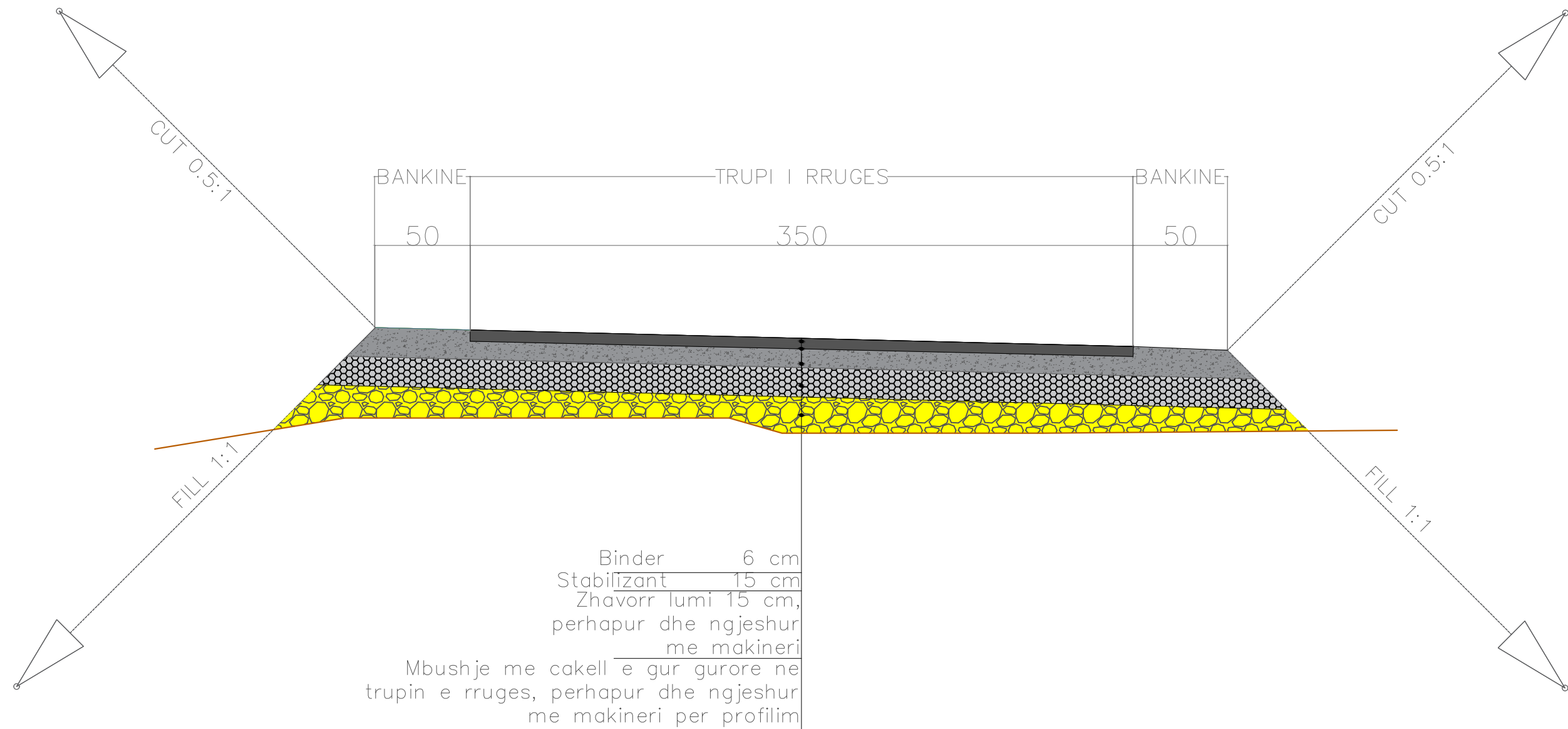

Porositi :  
BASHKIA  
MALESI E  
MADHE

Projektoi:  
"LENI-ING" sh.p.k  
Liçense: N.2969  
ADMINISTRATOR Nikoll PALUCA  
Adresa: Rr. Uran Pano, Pallati 12 kat, Kati 2  
Mobile: 0682042270  
Email: leni-ing@hotmail.com

Objekti: **Sistemim Asfaltim rruga e Kishes Selce**

Faza: Projekt – Zbatim

Emërtimi i Fletës:  
**PROFILI  
TERTHORE**

Shkalla:  
**1:25**

Tiranë 2023  
PT

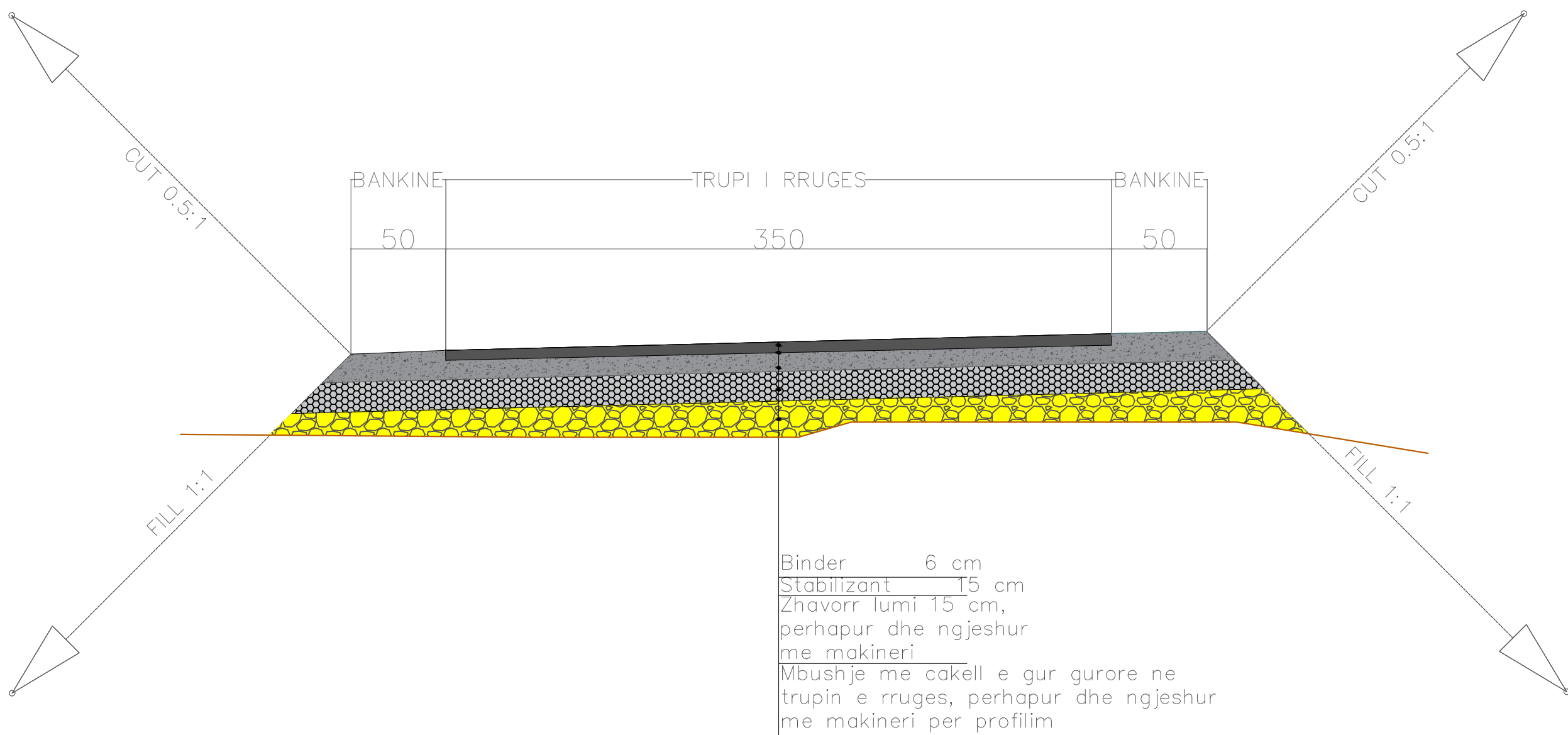

Binder 6 cm  
 Stabilizant 15 cm  
 Zhavorr lumi 15 cm,  
 perhapur dhe ngjeshur  
 me makineri  
 Mbushje me cakell e gur gurore ne  
 trupin e rruges, perhapur dhe ngjeshur  
 me makineri per profilim

Porositi : BASHKIA MALESI E MADHE	Projektoi: "LENI-ING" sh.p.k Liçense: N.2969 ADMINISTRATOR Nikoll PALUCA Adresa: Rr. Uran Pano, Pallati 12 kat, Kati 2 Mobile: 0682042270 Email: leni-ing@hotmail.com	Objekti: <b>Sistemim Asfaltim rruga e Kishes Selce</b>	
		Faza: Projekt – Zbatim	
		Emërtimi i Fletës: <b>PROFILI TERTHORE</b>	Shkalla: <b>1:25</b>

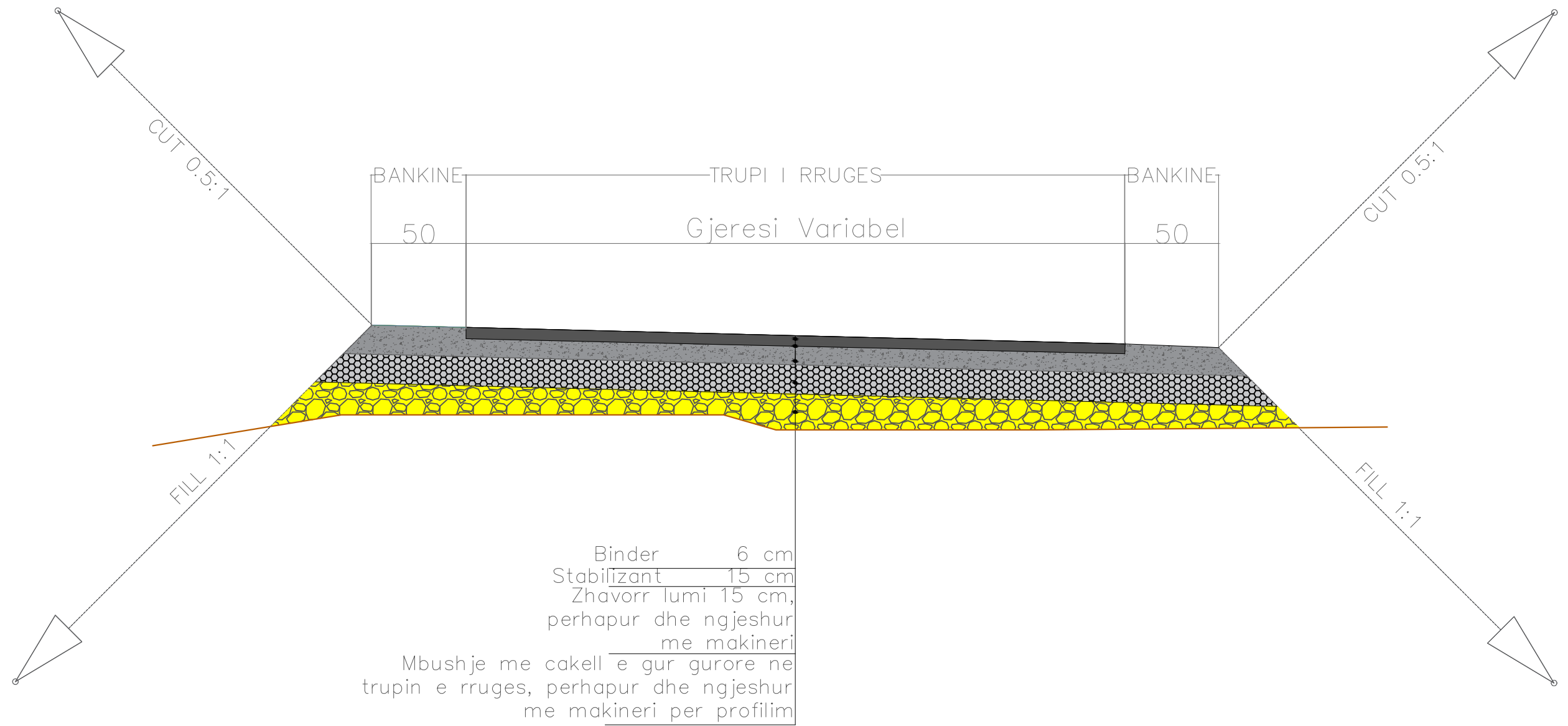

Porositi :  
BASHKIA  
MALESI E  
MADHE

Projektoi:  
"LENI-ING" sh.p.k  
Liçense: N.2969  
ADMINISTRATOR Nikoll PALUCA  
Adresa: Rr. Uran Pano, Pallati 12 kat, Kati 2  
Mobile: 0682042270  
Email: leni-ing@hotmail.com

Objekti: **Sistemim Asfaltim rruga e Kishes Selce**

Faza: Projekt – Zbatim

Emërtimi i Fletës:  
**PROFILI  
TERTHORE**

Shkalla:  
**1:25**

Tiranë 2023  
PT  
(3)

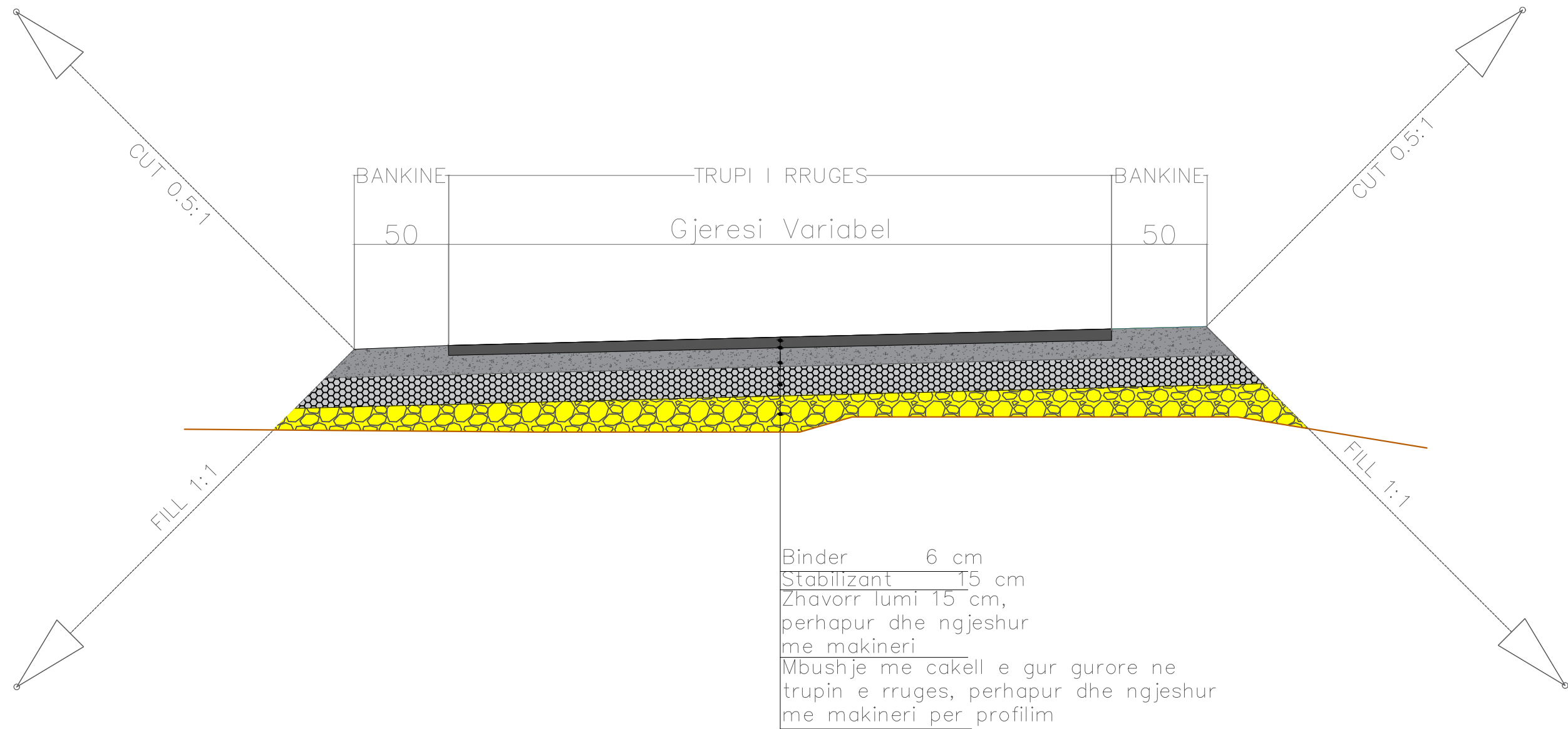

Porositi : BASHKIA MALESI E MADHE	Projektoi: "LENI-ING" sh.p.k Liçense: N.2969 ADMINISTRATOR Nikoll PALUCA Adresa: Rr. Uran Pano, Pallati 12 kat, Kati 2 Mobile: 0682042270 Email: leni-ing@hotmail.com	Objekti: <b>Sistemim Asfaltim rruga e Kishes Selce</b>	
		Faza: Projekt – Zbatim	
Emërtimi i Fletës: <b>PROFILI TERTHORE</b>	Shkalla: <b>1:25</b>	Tiranë 2023	
		PT (4)	